

LCD Monitor

M4210C-BA

42" LCD Widescreen 16:9 HD Capable Monitor



42" LCD HD CAPABLE MONITOR



- 42" LCD widescreen HD Capable Monitor
- **New!** IP Solution Capable
- **New!** Narrow Bezel (29mm)
- 1366 x 768 (WXGA) Display Resolution
- Convenient External Speaker-out
- Portrait-capable Mode
- Split Zoom (Self Video Wall) up to 4 x 4 matrix
- 450 cd/m² Brightness
- 1600:1 Contrast Ratio
- HDMI™ Interface
- Super IPS™ 178 degree Viewing Angle
- OSD and Remote Control Lock
- RS-232C Control
- 10W 2ch Speakers (Optional)



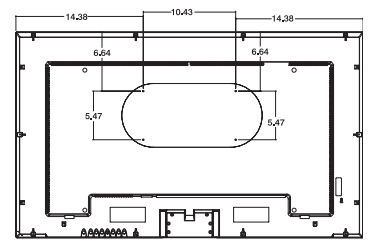
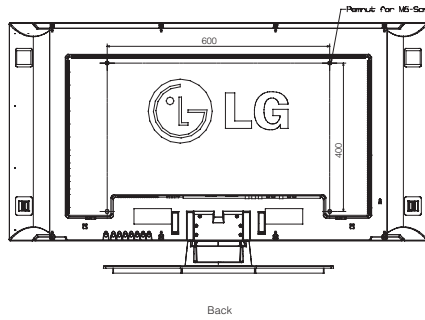
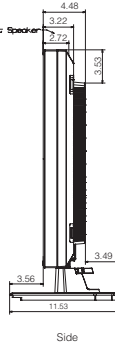
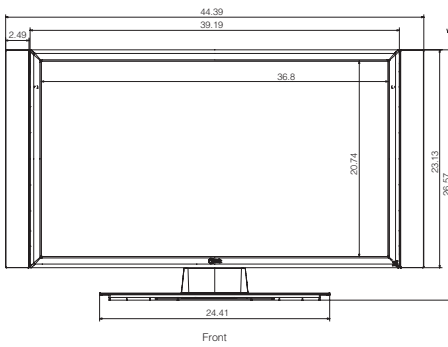

D-BOX MOUNTING HOLES FOR MODEL M4210C-BA

SPECIFICATIONS

PANEL

Screen Size	42"
Aspect Ratio	16 : 9
Native Resolution	1366 x 768 (WXGA)
Pixels (H x V x 3)	3,147,264
Brightness	450 cd/m ²
Contrast Ratio	1600 : 1
Viewing Angle (H x V)	178 x 178
Color Depth	16.7 Million (8 bits)
Response Time	9 ms (G to G)
Surface Treatment	Hard Coating (3H), Anti-glare
MTBF	50,000 Hr. (Minimum)

VIDEO

Max Input Resolution	1600 x 1200 @ 60Hz (Analog) 1280 x 1024 @ 60Hz (Digital)
Recommended Resolution	1360 x 768 @ 60Hz (Analog / Digital)
H-Scanning Frequency	30 ~ 83kHz (Analog / Digital)
V-Scanning Frequency	56 ~ 75 Hz
Pixel Frequency	165 MHz (D-Sub) / 135 MHz (HDMI/DVI)
Sync Compatibility	Separate / Composite / SOG
Video Input	RGB Analog / Digital
EZ Picture / PSM	Dynamic / Standard / Mild / User1 / User2
CSM	Warm / Normal / Cool / User
XD Engine®	Yes
Enhanced Noise Reduction	3D NR/(MPEG NR)
Digital Comb Filter	3D
DLTI/DCTI	Yes
Cinema 3:2/2:2 mode	Yes
Aspect Ratio Correction	Spectacle / Full / Original / 4:3 / 16:9 / 14:9 / Zoom

REAR JACK PACK

Component Video	2 Hi-Res (BNC)
PC Input via 15-Pin Sub "D"	1 / 1 (RGB)
Input/Output	
Composite Video Input/Output	1 / 1
Audio Output	1
Audio Inputs	3 Plus PC Sound
HDTV Formats	720p / 1080i
PC Formats	Auto Scaling to XGA
HDMI / HDCP	Yes (HDMI to DVI cable included)
RS-232C Input/Output	1 (Service/Control) / 1
S-Video	1 (S-Video has a priority but there is no input mode)
Audio Jack Built-in(No Amp)	Yes
Discrete IR Input	Yes
External Speaker Jack Out	Yes

AUDIO

On Screen Equalizer	Yes
EZ SoundRite/Auto Volume Limiter	Yes
Audio Power	20W (10W x 2)
Bass/Treble/Balance	Yes
EZ Sound/SSM	Surround MAX / Flat / Music / Movie / Sports / User

INTERFACE

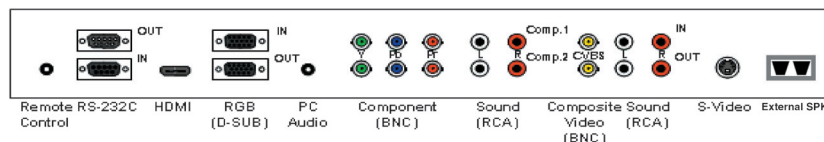

SPECIAL FEATURES

Temperature Sensor	Yes
Lamp Fault Sensor	Yes
Split Zoom (Self Video Wall, Max 4 x 4)	Yes
Source Selection	Digital (HDMI/DVI) / Analog (RGB) / Component1,2 / AV

Brightness/Contrast	Yes
Color	Warm / Normal / Cool

Position Tracking	H / V
Set-up	Auto / Clock / Phase

ISM Method

XD	Language (English / French / Spanish / Korean / Italian / German / Portugues)
Advanced Time	Normal / White wash / Orbiter / Inversion
Special Mute	XD Contrast / XD Color / XD NR / MPEG NR
Sleep Timer	Cinema / Black level
Auto Power/Source Memory	Clock / Off time / On time
Child Lock	Auto Adjust, OSD Lock
Power indicator/Logo light	Yes

CABINET

Color	Black
Monitor Dimension (W x H x D)	39.20" x 23.13" x 4.48"
Weight	74.8 Lbs.
Monitor with Optional Stand (ST4210K) Dimensions (W x H x D)	39.20" x 26.54" x 11.54"
Weight	77.6 Lbs.
Monitor with Optional Stand (ST4210K) & Optional Speaker (SP4210K) Dimensions (W x H x D)	49.57" x 26.54" x 11.54"
Weight	77.6 Lbs.
Carton Dimensions (W x H x D)	46.77" x 35.51" x 15.04"
Packed Weight	99.2 Lbs.
VESA™ Standard Mount Interface	600 x 400

POWER

Power Supply	100-240V~, 50/60Hz
Power Type	Built-in Power
Power Switch Type	Tact Switch
Power Saving	
Normal	240 W
Stand-by/Suspend	1W (RGB) / 4 W (HDMI/DVI)
DPM Off	1W (RGB) / 4 W (HDMI/DVI)
Switch Off	1 W

STANDARD (CERTIFICATION)

Safety	UL / c-UL / CB scheme / TUV / NEMKO
EMC	FCC Class "B" / VCCI / C-tick / GOST / CE / MIC
UPC	719192183568

