

**MITSUBISHI  
ELECTRIC**

**PRESENTATION PRODUCTS**

**LDT421V**

**42" LCD Retail and  
Digital Signage Monitor**



**1 High quality image for various business applications**

The native resolution of 1366X768 (WXGA), high contrast ratio of 1500:1 and 500cd/m<sup>2</sup> high brightness ensures clear and crisp picture quality.



portrait viewing

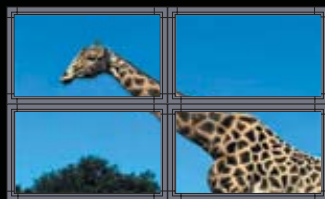

multi screen

**2 Scheduling Function ideal for digital display signage**

The Scheduling Function can automatically switch your display ON and OFF. It can manage up to seven preset programs and multiple input signals.



**3 Screen Saver functions for long term operation**

The LDT421V includes screen saver functions to help expand the lifetime of the LCD panel. It includes screen saving setting such as gamma selections, cooling-fan operation, brightness level, and image orbiter function.

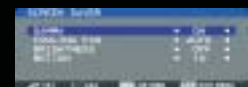

## Connectivity

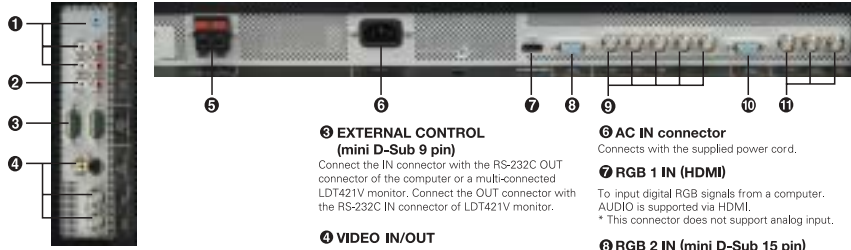

### 1 AUDIO IN 1, 2, 3

To input audio signal from external equipment such as a computer, VCR or DVD player.

### 2 AUDIO OUT

To output the audio signal from the AUDIO IN 1, 2 and 3 jack.

### 3 EXTERNAL CONTROL (mini D-Sub 9 pin)

Connect the IN connector with the RS-232C OUT connector of the computer or a multi-connected LDT421V monitor. Connect the OUT connector with the RS-232C IN connector of LDT421V monitor.

### 4 VIDEO IN/OUT

#### VIDEO IN connector (BNC and RCA):

To input a composite video signal. BNC and RCA are not available at the same time. (Use only one input).

**VIDEO OUT connector (BNC):** To output the composite video signal from VIDEO IN connector.

**S-VIDEO IN connector (MINI DIN 4 pin):** To input the S-Video (Y/C separate signal).

#### EXTERNAL SPEAKER TERMINAL

To output the audio signal for external speakers from AUDIO 1, 2 or 3 jack.

### 5 AC IN connector

Connects with the supplied power cord.

### 6 RGB 1 IN (HDMI)

To input digital RGB signals from a computer. AUDIO is supported via HDMI.  
\* This connector does not support analog input.

### 7 RGB 2 IN (mini D-Sub 15 pin)

To input the analog RGB signals from a computer or other RGB equipment.

### 8 RGB 3 IN [R, G, B, H, V] (BNC)

To input the analog RGB signals from a computer or other RGB equipment.

### 9 RGB OUT (mini D-Sub 15 pin)

To output the signal from RGB 2 IN or 3 IN.

### 10 DVD/HD IN [Y, Pb/Cb, Pr/Cr] (BNC)

Connecting equipment such as a DVD player, HDTV device, or Laser disc player.

## Optional Speakers

Weight:

2.6lbs (1.2kg) x2

Audio Output:

7W+7W (8Ω)

SP-421V

### SIZE

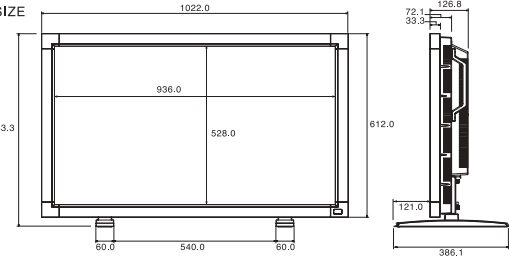

## Specifications

		LDT421V	
Item		Analog input	Digital input
LCD module	Pixel pitch	TFT active matrix, 42" (1067mm) diagonal	
	Resolution	0,681mm (H) x 0,681mm (V)	
	Color	1366 x 768 dots (WXGA)	
	Brightness (typ.)	16,7 Million	
	Contrast ratio (typ.)	500cd/m <sup>2</sup>	
	Viewing angle (typ.)	1500:1	
	Response time (typ.)	Up 89° / Down 89° / Left 89° / Right 89° (CR≥10)	
Frequency	Horizontal	20ms (GTG: 8ms)	
	Vertical	15.625/15.743, 31.5 - 91.1kHz (Analog/Digital)	
Pixel clock	13.5 - 165.0MHz	50.0/58.0 - 85.0Hz (Analog/Digital)	
Viewable size	930mm x 523mm / 36.6" x 20.6"		
Power management	Yes / VESA DPM		
Plug and play	Yes / VESA DDC2B, DDC / CI		
Auto adjustment	Yes (Contrast / Position / Phase / Clock)		
OSD user function	Brightness, Contrast, Black level, Zoom, PIP, Screen saver, Side border colour, Gamma selection, Black level expansion, Heat status, Power ON delay, Schedule, Tiling, etc.		
Speaker/Audio output	External speaker jack 7W+7W 8 ohm		
Input/Output signal	PC input/output	External speaker jack 7W+7W 8 ohm	
	Analog video input/output level	Analog RGB: 0.7Vp-p Input impedance 75 ohm	TMDS (with HDCP)
	Sync. input/output level	Separate: TTL level (Posi/Nega) 2.2k ohm terminated/Sync on Green	-
	Input connectors	BNC (R, G, B, H, V) Mini D-SUB 15pin	HDMI with digital audio support
	Output connector	Mini D-SUB 15pin	-
	Video input	Composite 1.0Vp-p input impedance 75 ohm BNC and RCA input (Exclusive)	
	Input impedance 75 ohm	Y / C Y: 1.0Vp-p C: 0.3Vp-p input impedance 75 ohm S-Terminal-input	
	Video output	Component 1.0/0.7Vp-p input impedance 75 ohm BNC input (HDTV: 50/60Hz)	
	Audio input	Composite 1.0Vp-p Input impedance 75 ohm BNC Output	
	Audio line output	RCA pin jack L/R x 2, Stereo mini jack x 1	
Control input/output	RCA pin jack L/R x 1		
Power supply	Mini D-SUB 9pin x 1 (input)/Mini D-SUB 9pin (output) (RS-232C)		
Current rating	Universal (AC100 - 240V)		
Operational environment	Temperature	2.3A @ 100 - 120V, 1.05A @ 220 - 240V	
	Humidity	5 to 40°C / 41 to 104°F (Landscape Mode), 5 to 35°C / 41 to 95°F (Portrait Mode)	
Storage environment	Temperature	20 - 80% (without condensation)	
	Humidity	-20 to 60°C / -4 to 140°F *For longer life usage of LCD monitor, operation 25°C / 77°F at ambient temperature is recommended.	
Dimension	Net with stand	10 - 90% (without condensation), 90-3.5 x (Temp -40°C)% regarding over 40°C / 104°F	
	Net without stand	1022mm (W) x 643.3mm (H) x 386.1mm (D) / 40.24" (W) x 25.33" (H) x 15.2" (D)	
	Gross	1022mm (W) x 612.0mm (H) x 126.8mm (D) / 40.24" (W) x 24.09" (H) x 4.99" (D)	
Weight	Net	1180mm (W) x 758.0mm (H) x 290.0mm (D) / 46.46" (W) x 29.84" (H) x 11.42" (D)	
	Gross	Approx. 27.4kg / 60.3 lbs (with stand) Approx. 26.0kg / 57.2 lbs (without stand)	
Wall mounting interface	12 Holes (100mm / 3.9" pitches)		
Complied regulatory and guidelines	UL60950-1 / C-UL / TUV-GS / EN60950-1 / BSMI / PSB / FCC-B / DOC-B / EN55022-B / EN55024 / EN61000-3-2 / EN61000-3-3 / C-Tick / RoHS / CE / GOST / US Mercury / CCC only for Chinese model		
Accessories	Power Cord, VGA (Mini-Dsub15p) Cable, User's Manual, Wireless Remote Controller, Battery x2, Clamper x2, Screw for Clamper x2, Screw for Main Switch Cover x2, Main switch cover, Cable Holder x2, Band x2, Screw for Stand x4, Stand x1 pair		
Warranty	Toll-free 24x7 technical support access; 3-years parts and labor warranty; Onsite warranty repairs and service availability		

LCD panels are manufactured using high precision technology; nevertheless there may be some missing pixels and some pixels might be always lit on. ● Displaying still pictures for long term may cause permanent image sticking. ● Windows® is a registered trademark of Microsoft Corporation of US in the territory of US and others. ● Macintosh is a registered trademark of APPLE INC. US in the territory of US and others. ● Company and product names are a registered trademark or trademark of the relative company. ● HDMI, **HDMI** and High-Definition Multimedia Interface™ are trademarks or registered trademarks of HDMI Licensing LLC.



PRESENTATION PRODUCTS

MITSUBISHI DIGITAL ELECTRONICS AMERICA, INC.  
Presentation Products Division  
Toll Free: 888.307.0349  
Email: ppdinfo@mdea.com  
[www.mitsubishi-presentations.com](http://www.mitsubishi-presentations.com)

Canada  
Mitsubishi Electric Sales Canada Inc.  
Information Technologies Group  
Phone: 905.475.7728  
[www.mitsubishielectric.ca](http://www.mitsubishielectric.ca)