



**Contact SAMSUNG WORLDWIDE**

If you have any questions or comments about your Samsung TV, please contact the SAMSUNG customer care center.

Country	Customer Care Center ☎	Web Site	Address
CANADA	1-800-SAMSUNG (726-7864)	www.samsung.com	Samsung Electronics Canada Inc., Customer Service 55 Standish Court Mississauga, Ontario L5R 4B2 Canada
U.S.A	1-800-SAMSUNG (726-7864)	www.samsung.com	Samsung Electronics America, Inc. 85 Challenger Road Ridgefield Park, NJ 07660



SERIES **8+**  
8000

# Plasma TV

## user manual



Thank you for purchasing this Samsung product.  
To receive more complete service, please register  
your product at  
[www.samsung.com/register](http://www.samsung.com/register)

Model \_\_\_\_\_ Serial No. \_\_\_\_\_

☎ If you have any questions, please call us at 1-800-SAMSUNG (1-800-726-7864) for assistance.



A detailed User's Manual is built into your TV. For more information about how to view this e-Manual see page 48.

Figures and illustrations in this User Manual are provided for reference only and may differ from actual product appearances. Product design and specifications may be changed without notice.

## Important Warranty Information Regarding Television Format Viewing

 See the warranty card for more information on warranty terms.

Wide screen format PDP Displays (with 16:9 aspect ratios, the ratio of the screen width to height) are primarily designed to view wide screen format full-motion video. The images displayed on them should primarily be in the wide screen, 16:9 ratio format, or expanded to fill the screen, if your model offers this feature, with the images constantly in motion. Displaying stationary graphics and images on the screen, such as the dark sidebars on non-expanded standard format television video and programming, should be limited to no more than 5% of the total television viewing per week.

Additionally, viewing other stationary images and text such as stock market reports, video game displays, station logos, web sites or computer graphics and patterns, should be limited as described above for all televisions. Displaying stationary images that exceed the above guidelines can cause uneven aging of PDP Displays that leave subtle, but permanent burned-in ghost images in the PDP picture. To avoid this, vary the programming and images, and primarily display full screen moving images, not stationary patterns or dark bars. On PDP models that offer picture sizing features, use these controls to view different formats as a full screen picture.

Be careful about the television formats you select and the length of time you view them. Uneven PDP aging as a result of format selection and use, as well as burned in images, are not covered by your Samsung limited warranty.

- **SAMSUNG ELECTRONICS NORTH AMERICAN LIMITED WARRANTY STATEMENT**

Subject to the requirements, conditions, exclusions and limitations of the original Limited Warranty supplied with Samsung Electronics (SAMSUNG) products, and the requirements, conditions, exclusions and limitations contained herein, SAMSUNG will additionally provide Warranty Repair Service in the United States on SAMSUNG products purchased in Canada, and in Canada on SAMSUNG products purchased in the United States, for the warranty period originally specified, and to the Original Purchaser only.

The above described warranty repairs must be performed by a SAMSUNG Authorized Service Center. Along with this Statement, the Original Limited Warranty Statement and a dated Bill of Sale as Proof of Purchase must be presented to the Service Center. Transportation to and from the Service Center is the responsibility of the purchaser. Conditions covered are limited only to manufacturing defects in material or workmanship, and only those encountered in normal use of the product.

Excluded, but not limited to, are any originally specified provisions for, in-home or on-site services, minimum or maximum repair times, exchanges or replacements, accessories, options, upgrades, or consumables.

For the location of a SAMSUNG Authorized Service Center, please call toll-free:

– In the United States : 1-800-SAMSUNG (1-800-726-7864)

– In Canada : 1-800-SAMSUNG

## User Instructions

- **Screen Image retention**

Do not display a still image (such as on a video game) on the plasma display panel for more than several minutes as it can cause screen image retention. This image retention is also known as 'screen burn'. To avoid such image retention, refer to e-Manual to reduce the degree of brightness and contrast of the screen when displaying a still image.

- **Heat on the top of the Plasma TV**

The top side of the product may be hot after long periods of use as heat dissipates from the panel through the vent hole in the upper part of the product. This is normal and does not indicate any defect or operation failure of the product. However, children should be prevented from touching the upper part of the TV.

- **The TV is making a 'cracking' noise.**

A 'cracking' noise may occur when the product contracts or expands due to a change in the surrounding environment such as temperature or humidity. This is normal and not a defect of the unit.

- **Cell Defects**

Your plasma TV has a panel containing 2,360,000 (HD-level) to 6,221,000 (FHD-level) pixels which require sophisticated technology to produce. However, there may be a few bright or dark pixels on the screen. These pixels will have no impact on the performance of the product.

- **Avoid operating the TV at temperatures below 41°F (5°C)**

- **A still image displayed too long may cause permanent damage to the PDP Panel.**



Watching the Plasma TV in 4:3 format for a long period of time may leave traces of borders displayed on the left, right and center of the screen caused by the difference of light emission on the screen. Playing a DVD or a game console may cause similar effects to the screen. Damages caused by the above effect are not covered by the Warranty.

- **After-images on the Screen.**

Displaying still images from Video games or a PC for longer than a certain period of time may produce partial after-images.

To prevent this effect, reduce the 'brightness' and 'contrast' when displaying still images for a long time.

- **Warranty**

Warranty does not cover any damage caused by image retention. Burn-in is not covered by the warranty.

- **Caution**



The glass screen of your PDP TV can break if you accidentally drop the TV. Handle the TV with care.

When moving the TV, always have two or more people pick it up and carry it as a safety precaution. Do not lay the TV flat on its face or back.

Your Samsung Plasma TV is a high quality television that has been carefully packaged to protect the integrity of its glass panel and component parts during shipment. It is, nonetheless, a fragile piece of electronics that requires careful handling. Refrain from putting undue stress on any part of the packaging when shipping or unpacking the TV. Use care when installing the TV. Avoid placing the TV in a location where it may be struck, exposed to sharp impacts, or fall. Panel breakage caused by a fall or impact strike is not covered under the manufacturer's warranty.

## Contents

- Important Warranty Information Regarding Television Format Viewing ..... 2
- User Instructions ..... 2
- Contents ..... 3
- List of Features ..... 4
- Accessories and Cables ..... 5
- Installing the Stand ..... 7
- Installing the Wall Mount (Optional) ..... 9
- Providing Proper Ventilation for Your TV ..... 11
- Using the TV's Controller (Panel Key) ..... 12
- Connecting the Power Cord and the Antenna or Cable Connection ..... 13
- The Standard Remote Control ..... 14
- How to Navigate Menus ..... 16
- Configuring the Basic Settings in Initial Setup ..... 17
- Connecting to AV Devices (Blu-ray Players, DVD Players, etc.) ..... 21
- Connecting to Audio Devices ..... 23
- Connecting to a PC ..... 24
- The EX-Link Cable Connection ..... 24
- Changing the Input Source ..... 25
- Using Smart Hub ..... 26
- SMART Interaction ..... 27
  - Voice Control ..... 27
  - Motion Control ..... 30
  - Face recognition ..... 32
- The Evolution Kit Slot (Kit Sold Separately) .... 34
- Connecting to a Network ..... 35
- Configuring Network Connections ..... 37
- The Smart Touch Control ..... 39
- The IR Blaster ..... 43
- Setting up the Universal Remote Control ..... 45
- Using the Search for Recommended Model Code ..... 47
- How to view the e-Manual ..... 48
- Troubleshooting ..... 50
- Licenses ..... 53
- Storage and Maintenance ..... 53
- Specifications - Smart Touch Control ..... 56
- Specifications - IR Blaster ..... 56
- Specifications ..... 57
- Display Resolution ..... 58
- Video Codec ..... 59
- Dimensions ..... 60
- Index ..... 61

## List of Features

- **3D:** This exciting new feature enables you to view 3D content.
- **SMART HUB:** Your gateway to all your content, integrated in one place.
  - Provides diverse entertainment choices.
  - Lets you control your entertainment life with an easy-to-use, user friendly user interface.
  - Gives you easy access to diverse apps, with more being added every day.
  - Lets you customize your TV by grouping and sorting apps to your taste.
- **AllShare Play:** Lets you access, view, or play photos, videos, or music located on USB devices, digital cameras, cell phones, and PCs. PCs and cell phones can be accessed wirelessly, through your wireless network.
- **Anynet+ (HDMI-CEC):** Allows you to control all connected Samsung devices that support Anynet+ with your Samsung TV's remote.
- **e-Manual:** Provides a detailed, on-screen user's manual that's built into your TV. (page 48)
- **SMART Interaction:** Using this function, you can access and control menu options and functions using speech or motions. (page 27)

## Accessories and Cables

- ✎ Please make sure the following items are included with your TV. If any items are missing, contact your dealer.
- ✎ The items' colors and shapes may vary depending on the model.
- ✎ Make sure that there are no accessories hidden behind or under packing materials after you open the box.

- Smart Touch Control (AA59-00626A) & Batteries (AA x 2)
- IR Blaster (BN96-22897A) & Batteries (AA x 4)
- Remote Control (AA59-00637A) & Batteries (AAA x 2)
- User Manual
- Cleaning Cloth (BN63-01798B)
- Warranty Card / Safety Guide
- 3D Active Glasses
- Power Cord

### Input Cables (Sold Separately)

You will need one or more of these cables to connect your TV to your antenna or cable outlet and your peripheral devices (Blu-ray players, DVD players, etc.)

To purchase the RS232 cable, contact [www.SamsungParts.com](http://www.SamsungParts.com).



RS232 (AA39-00311A)



HDMI



HDMI-DVI



Audio



Component





Composite (AV)

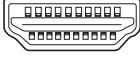
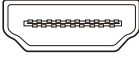
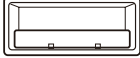

Coaxial (RF)

 Make sure you have the correct cable before plugging it in. Illustrations of common plugs and jacks are below.

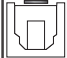
	Cable Plugs	Ports / Jacks
HDMI		
USB		
Optical		



**Warning**

Do not plug cables in upside down.  
Be sure to check the orientation of the plug before plugging it in.

### Wireless Keyboard (Sold Separately)

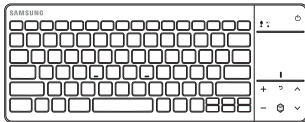

Wireless Keyboard

## Installing the Stand

**Stand Parts:** 51 inches model only

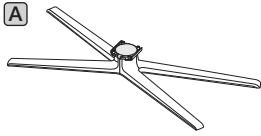

Stand x 1

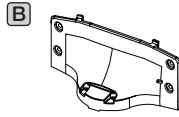

Guide Stand x 1



Screws x 8

Follow the steps below to connect the TV to the stand. For more detailed instructions, see the separate stand installation guide.

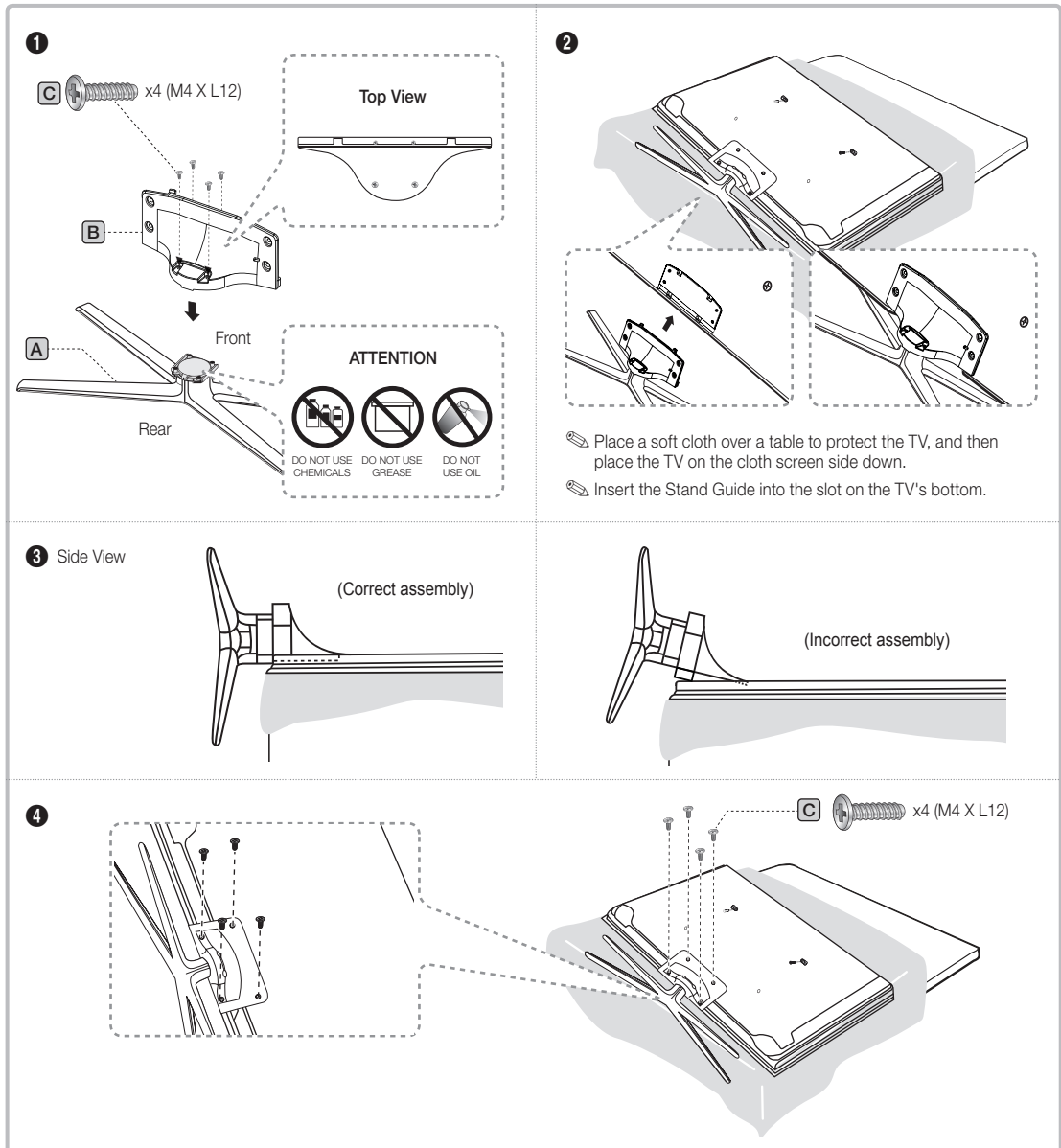

**Stand Parts:** 60, 64 inches model only

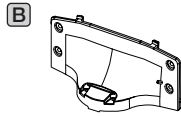
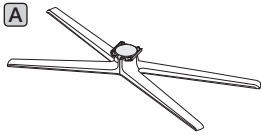

Stand x 1

Guide Stand x 1

Screws x 8

Follow the steps below to connect the TV to the stand. For more detailed instructions, see the separate stand installation guide.

**1**

**2**

**3** Side View

**4**



## NOTE

- Make sure to distinguish between the front and back of each component when assembling them.
- Make sure that at least two people lift and move the TV.
- Stand the product up before you tighten the screws. If you tighten the screws with the TV lying down, it may lean to one side when you stand it up.

 **Do not insert your fingers into the stand base slot of the TV when installing the stand base.**

## Installing the Wall Mount (Optional)



### Wall or Ceiling Mounting

If you mount this product on a wall, it should be mounted only as recommended by the manufacturer. Unless it is correctly mounted, the product may slide or fall, causing serious injury to a child or adult, and serious damage to the product.

### Installing the Wall Mount Kit

The wall mount kit (sold separately) lets you mount the TV on the wall.

For detailed information about installing the wall mount, see the instructions provided with the wall mount. We recommend you contact a technician for assistance when installing the wall mount bracket. We do not advise you to do it yourself. Samsung Electronics is not responsible for any damage to the product or injury to yourself or others if you elect to install the wall mount on your own.

To order the wall mount kit, contact Samsung Customer Care at 1-800-SAMSUNG (1-800-726-7864).

### VESA Wall Mount Kit Notes and Specifications

 Install your wall mount on a solid wall perpendicular to the floor. Before attaching the wall mount to surfaces other than plaster board, please contact your nearest dealer for additional information. If you install the TV on a ceiling or slanted wall, it may fall and result in severe personal injury.

## NOTE

- Standard dimensions for wall mount kits are shown in the table below.
- Samsung wall mount kits contain a detailed installation manual and all parts necessary for assembly are provided.
- Do not use screws that do not comply with the VESA standard screw specifications.
- Do not use screws that are longer than the standard length or do not comply with the VESA standard screw specifications. Screws that are too long may cause damage to the inside of the TV set.
- For wall mounts that do not comply with the VESA standard screw specifications, the length of the screws may differ depending on the wall mount specifications.
- Do not fasten the screws too firmly. This may damage the product or cause the product to fall, leading to personal injury. Samsung is not liable for these kinds of accidents.

- Samsung is not liable for product damage or personal injury when a non-VESA or non-specified wall mount is used or the consumer fails to follow the product installation instructions.
- Do not mount the TV at more than a 15 degree tilt.
- Always have two people mount the TV on a wall.

Product Family	TV size in inches	VESA screw hole specs (A * B) in millimeters	Standard Screw	Quantity
PDP TV [Ultra-Slim]	~51	400 X 400	M8	4
	59~64	600 X 400		

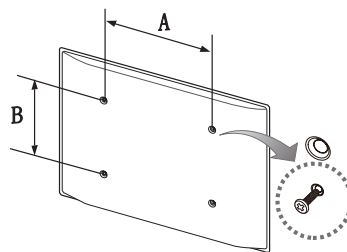

 Remove the screws in the mounting holes before you install the wall mount.



Do not install your Wall Mount Kit while your TV is turned on. It may result in personal injury due to electric shock.

### Installing a Wall Mount from Another Manufacturer

To install a wall-mount from another manufacturer, use the Holder-Ring.

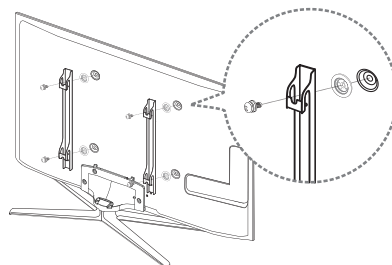

## Providing Proper Ventilation for Your TV

When you install your TV, maintain a distance of at least 4 inches between the TV and other objects (walls, cabinet sides, etc.) to ensure proper ventilation. Failing to maintain proper ventilation may result in a fire or a problem with the product caused by an increase in its internal temperature.

- ✎ Whether you install your TV using a stand or a wall-mount, we strongly recommend you use parts provided by Samsung Electronics only.
  - If you use parts provided by another manufacturer, it may cause difficulties with the product or result in injury caused by the product falling.

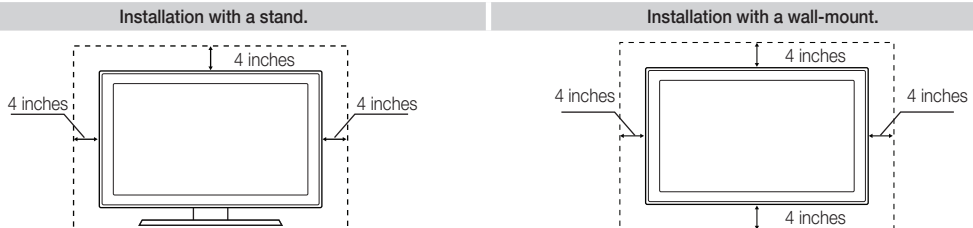

### Other Warnings



- ✎ The actual appearance of the TV may differ from the images in this manual, depending on the model.
- ✎ Be careful when you touch the TV. Some parts can be somewhat hot.

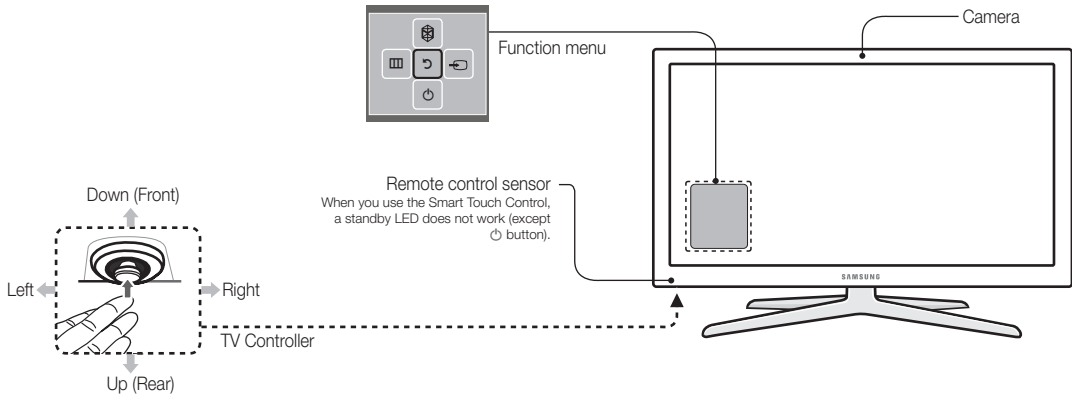

## Using the TV's Controller (Panel Key)

The TV's Controller, a small joy stick like button on the bottom left side of the TV, lets you control the TV without the remote control.

 The product color and shape may vary depending on the model.



-  Follow these instructions facing the front of your TV.
-  When selecting the function by moving the controller to the up/down/left/right directions, be sure not to press the controller. If you press it first, you cannot operate it to move the up/down/left/right directions.
-  When you use a TV camera, you should check whether a tape attached or not in rear of the TV camera, and then you can use a TV camera after adjust a camera angle. When you don't want to use a TV camera, we recommend to use after a camera lens fixes to upwards. In this case, **Face recognition** and **Motion Control** are not available.

<b>Power on</b>	Turn the TV on by pressing the Controller when the TV is in standby mode.
<b>Adjusting the volume</b>	Adjust the volume by moving the Controller from side to side when the power is on.
<b>Selecting a channel</b>	Select a channel by moving the Controller backwards and forwards when the power is on.
<b>Using the Function menu</b>	To view and use the Function menu, press and release the Controller when the power is on. To close the Function menu, press and release the Controller again.
<b>Selecting the SMART HUB </b>	With the Function menu visible, select <b>SMART HUB </b> by moving the Controller backwards. The <b>SMART HUB</b> main screen appears. Select an application by moving the Controller, and then pressing the Controller.

<b>Selecting the MENU</b> (⏏)	With the Function menu visible, select the <b>MENU</b> (⏏) by moving the Controller to the left. The OSD (On Screen Display) Menu appears. Select an option by moving the Controller to the right. Move the Controller to the right or left, or backwards and forwards to make additional selections. To change a parameter, select it, and then press the Controller.
<b>Selecting a Source</b> (↔)	With the Function menu visible, open the <b>Source</b> (↔) list by moving the Controller to the right. The <b>Source</b> list screen appears. To select a source, move the Controller back and forth. When the source you want is highlighted, press the Controller.
<b>Power Off</b> (⏻)	With the Function menu visible, select <b>Power Off</b> (⏻) by moving the Controller forwards, and then press the Controller.

🔧 To close the **Menu**, **Smart Hub**, or **Source**, press the Controller for more than 1 second.

### Standby mode

Your TV enters Standby mode when you turn it off and continues to consume a small amount of electric power. To be safe and to decrease power consumption, do not leave your TV in standby mode for long periods of time (when you are away on vacation, for example). It is best to unplug the power cord.

## Connecting the Power Cord and the Antenna or Cable Connection

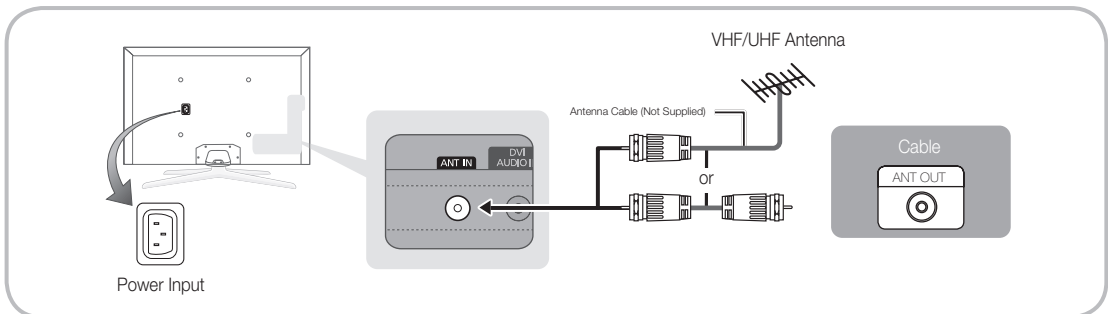

- 🔧 Plug the power cord into a wall outlet only after you have made all other connections.
- 🔧 If you are connecting your TV to a cable or satellite box using HDMI, Component, or Composite connections, you do not need to connect the ANT IN jack to an antenna or a cable connection.
- 🔧 The Plasma TV may interfere with an amateur radio or AM radio.
- 🔧 Using two-way radio mobile and portable units or amateur radio or AM radio near your TV may cause the TV to malfunction.
- 🔧 Use caution when you move or swivel the TV if the antenna cable is tightly connected. You could break the antenna jack off the TV.

## The Standard Remote Control

Learn where the function buttons are on your remote. Especially note **SOURCE**, **MUTE**, **VOL**, **CH**, **MENU**, **TOOLS**, **INFO**, **CH LIST**, **RETURN**, and **EXIT**.

 This remote control has Braille points on the Power, Channel, and Volume buttons and can be used by visually impaired persons.

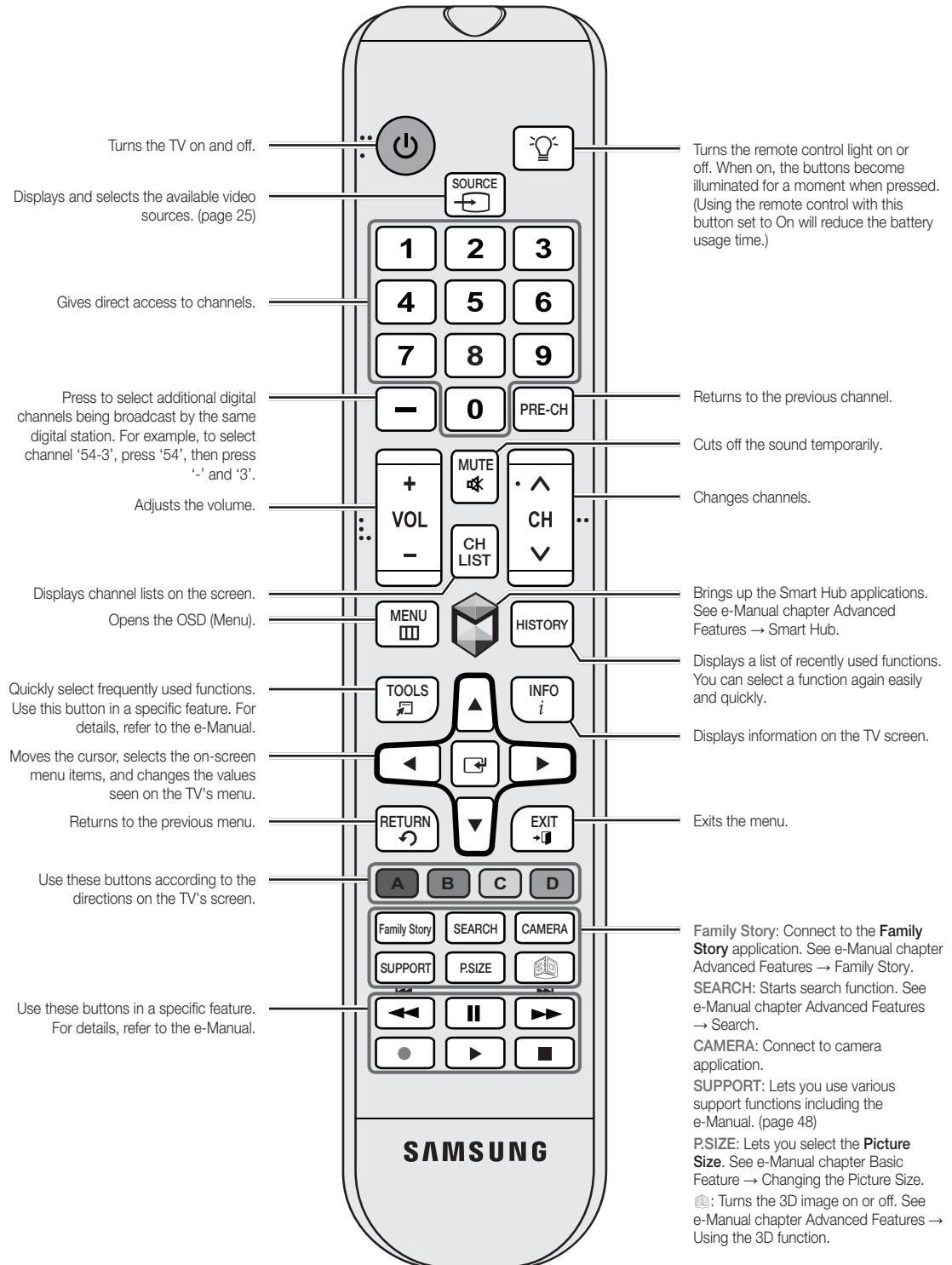

## Installing batteries (Battery size: AAA)

Match the polarity of the batteries to the symbols in the battery compartment.

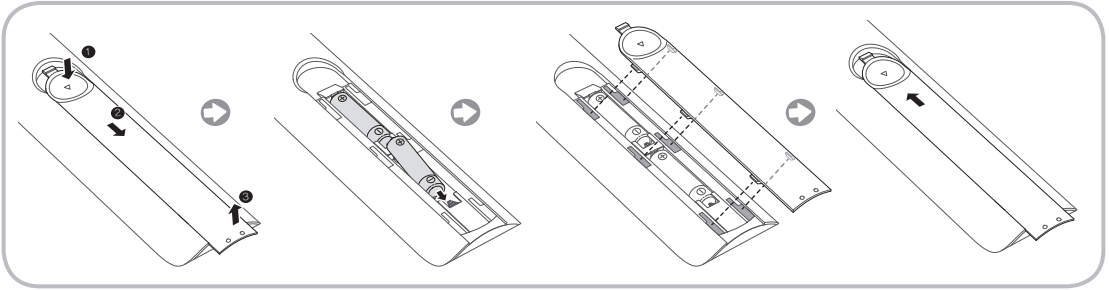

 Your TV also comes with a Smart Touch Control. For information about the Smart Touch Control, see page 39.

### **NOTE**

- Install the batteries so that the polarity of the batteries (+/-) matches the illustration in the battery compartment.
- Use the remote control within 23 feet of the TV.
- Bright light may affect the performance of the remote control. Avoid using it near fluorescent lights or neon signs.
- The color and shape of the remote may vary depending on the model.

## How to Navigate Menus

Your TV's Main and Tools menu contains functions that let you control the TV's features. For example, in the Main menu you can change the size and configuration of the picture, its brightness, its contrast and so on. There are also functions that let you control the TV's sound, channel configuration, energy use, and a host of other features. To access the main, on-screen menu, press the **MENU** button on your remote. To access Tools menus, press the **TOOLS** button. Tools menus are available when the **TOOLS** menu icon is displayed on the bottom right of the screen.

The illustration below displays the buttons on the standard remote you use to navigate the menus and select and adjust different functions. For information about using the Smart Touch Control, see page 39.

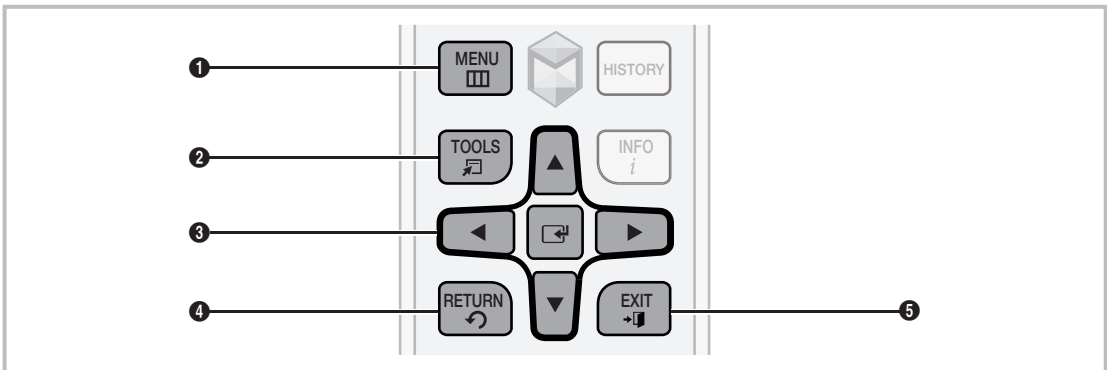

- ❶ **MENU** button: Displays the main on-screen menu.
- ❷ **TOOLS** button: Displays the Tools menus when available.
- ❸ **Enter** and **Direction** buttons: Use the **Direction** buttons to move the cursor and highlight an item. Use the **Enter** button to select an item or confirm the setting.
- ❹ **RETURN** button: Returns to the previous menu.
- ❺ **EXIT** button: Exits the on-screen menu.

### How to Operate the Main Menu (OSD - On Screen Display) Using the Standard Remote





The access steps may differ depending on the menu option you select.

<b>1</b>	<b>MENU</b>	The main menu options appear on the screen: <b>Picture, Sound, Channel, Network, System, Support.</b>
<b>2</b>	▲ / ▼	Select a main menu option on the left side of the screen with the ▲ or ▼ button.
<b>3</b>	Enter	Press Enter to access the sub-menus.
<b>4</b>	▲ / ▼	Select the desired submenu with the ▲ or ▼ button.
<b>5</b>	▲ / ▼ / ◀ / ▶	Adjust the value of an item with the ◀, ▶, ▲, or ▼ button. The adjustment in the OSD may differ depending on the selected menu.
<b>6</b>	Enter	Press Enter to confirm the selection.
<b>7</b>	<b>EXIT</b>	Press <b>EXIT</b> .



## Configuring the Basic Settings in Initial Setup

When you turn the TV on for the first time, a sequence of screens and on-screen prompts will assist you in configuring the TV's basic settings. Plug the power cord into a wall outlet, and then press the  button to turn on the TV.

-  Use the standard remote to run the Initial Setup.
-  **Setup** is available only when the input source is set to TV. See "Changing the Input Source" (page 25).
-  To return to the previous step in the **Setup** sequence, select **Previous**.
-  If you are not using a cable box or satellite box, make sure you have connected the TV to an antenna or cable connection before you turn on the TV. See page 13 for instructions.
-  If you want to configure a wired network connection during **Setup**, make sure you've connected a LAN cable to your TV. See pages 36 for instructions. If you want to configure a wireless network connection during **Setup**, make sure your wireless modem or router is on and working.

**1** **Menu Language:** Select a Language. After you press the  button, the Start screen appears. Select **Next** to continue. The Menu Language screen appears. Select the menu language you want using your remote, and then select **Next**. The TV will display on-screen menus using the language you select beginning with the next step in the **Setup** process.

**2** **Use Mode:** Select the Home Use Mode. On the **Use Mode** screen, select the **Home Use** using your remote, and then select **Next**. The Network Settings screen appears.

 **Store Demo** is for retail environments only. If you select **Store Demo**, some functions will not work, and the TV will reset all functions to their factory default after a certain period of time. For more information about **Store Demo**, go to the end of this section.





**3** **Network Settings:** Configure the network settings. To configure your network settings, select **Next** using your remote, and then go to 3A - **Wireless Network** or 3B - **Wired Network** on the next page.

 To configure later, select **Skip**. If you do not know your network configuration information or want to configure the settings later, or do not have a network, select **Skip**, and then go to 5 - **Auto Program** (1) on page 19.

You can set up the network connection later using the on-screen **Network** menu. To configure network settings later, refer to "Setting up the Wired or Wireless Network" in the e-Manual or see the Network Connection sections in this manual (pages 35 and 37).

### 3A

#### Wireless Network

1. The TV searches for and then displays all the wireless networks within range. When done, it displays a list of the networks. In the list of networks, move the Highlight to select a network, and then select **Next**. If the selected network requires a Security Key, the Security Key screen appears.
  -  If you have a WPS(PBC) compatible router, select **WPS(PBC)** instead, and then follow the directions on the screen. When done, go to Step 4.
2. Enter your network security key or WPS PIN using your remote.
  -  Enter numbers and letters using your remote.
    - If you are using the standard remote, you can enter numbers by pressing the number buttons on the remote.
    - To enter a letter, move the Highlight to the letter, and then select it. You can enter numbers in the same fashion if you choose.
  -  To display capital letters (or redisplay small letters if capital letters are displayed), select **Caps** or **Shift**.
  -  To display symbols and punctuation, select 1★. To redisplay letters, select 1★ again.
3. When done, select **Next** if you have entered a security key or **WPS PIN** if you have entered a WPS PIN.
4. The TV checks the wireless connection. If the connection is successful, the **You are connected to the Internet. If you have any problems using online services, please contact your Internet Service Provider.** message appears. Select **Next**, and then go to 4 **Software Upgrade** Step.
  -  If the connection fails, select **Previous**, repeat Step 1 and 2, carefully re-enter your security key or WPS PIN, then repeat Steps 3 and 4. If it fails again, select **Next** on the "Connection Failed" screen, and then go to 5 - **Auto Program** (1) on the next page. Configure your network later through **Network Settings** in the TV's Menu. For more information, refer to "Setting up the Wired or Wireless Network" in the e-Manual or see the Network Connection sections in this manual (pages 35 and 37).

### 3B

#### Wired Network

The TV checks the network connection, then displays the **You are connected to the Internet. If you have any problems using online services, please contact your Internet Service Provider.** message appears. Select **Next**. The **Software Upgrade** screen appears.

**4** **Software Upgrade:**  
Update the software to the latest version.

 To update later, select **Skip**.

When **Network Settings** is complete, your TV will check for a new software version automatically. If new software is available, the TV downloads and installs the new software. When the download is complete, select **Next**.

 If you want to upgrade later, select **Skip**. For more information, refer to **Software Update** (Preference Features → Support Menu) in the e-Manual.

 This may take some time, depending on your network status.

 You can only upgrade software if your TV has an active network connection.

 If no new update software is available, a no new updates message appears on the screen. Select **OK**.

**5** **Auto Program (1):**  
Select where your TV signal comes from.

Select the appropriate option for your TV using your remote, and then select **Next**.

- **Yes, I need to.:** Select if you have an antenna or a cable connection without a set-top box. If you select this option, go to 6 - **Auto Program (2)** Step.
- **No, I don't need to.:** Select if you have a satellite or cable set-top box. You do not need to run **Auto Program**. If you select this option, go to 8 - **Clock** on the next page.

**6** **Auto Program (2):**  
Select the search options.



1. Select **Air** or **Cable** using your remote. A check appears on your selection. When done, select **Next**. You can check both if you have both connected.
2. If you selected **Air**, go to 7 - **Auto Program (3)**.
3. If you selected **Cable**, you'll go to the cable system screen. Select **Digital Cable System**. The option window appears. Select the correct cable signal format; **STD**, **HRC**, or **IRC**. Most cable systems use **STD** (Standard). Repeat the same process with **Analog Cable System**.
4. When done, select **Next**.

**7** **Auto Program (3):**  
Channel memorization

Channel memorization starts. Channel memorization can take up to 45 minutes, depending on your cable system.

For more information, refer to **Auto Program** (Channel Menu → Memorizing Channels) in the e-Manual.

 Select **Stop** at any time to halt the memorization process.

8	<b>Clock:</b> Set the Clock.	<p>Select <b>Auto</b> or <b>Manual</b>, and then select <b>Next</b>.</p> <p> If you selected <b>No, I don't need to.</b> in 5 - <b>Auto Program</b> (1), you can only set the current time and date manually, using your remote.</p> <p><b>Auto</b></p> <p>If you selected <b>Auto</b>, the TV will automatically download the correct time from a digital channel. The <b>Time Zone</b> screen will appear. Select your <b>Time Zone</b>, and then select <b>Next</b>. The <b>DST</b> (Daylight Savings Time) screen will appear. The <b>DST</b> function sets the time ahead one hour to adjust the clock for Daylight Savings Time. Select <b>On</b> if you want to turn the DST adjustment on. Select <b>Off</b> to turn off the DST adjustment. You can also turn the DST function on through the TV's on screen menu (<b>Menu</b> → <b>System</b> → <b>Time</b> → <b>Clock</b> → <b>DST</b>).</p> <p><b>Manual</b></p> <p>If you selected <b>Manual</b>, you'll go to the <b>Clock</b> screen. Select <b>Date</b> or <b>Time</b>. You can set the current date and time using your remote. When done setting the <b>Date</b> and <b>Time</b>, select <b>Next</b>.</p>
9	<b>Voice and Motion Control:</b> Setting the Voice and Motion Control function.	<p>You can turn the <b>Voice and Motion Control</b> function on or off. Select <b>Off</b> or <b>On</b>, and then select <b>Next</b>.</p>
10	<b>Setup:</b> Complete	<p>Review the Setup data, and then select <b>Close</b> to finish.</p> <p> The completed settings are displayed.</p>
11	Set the Universal Remote.	<ol style="list-style-type: none"> <li>1. Turn on the <b>POWER</b> button on the bottom of the IR Blaster, and then press the <b>PAIRING</b> button.</li> <li>2. Select <b>Yes</b> to start the Universal Remote Setup.</li> </ol> <p> For more detailed information about the Universal Remote Setup, refer to "Setting up the Universal Remote Control" section in the manual (page 45).</p>

### If You Want to Rerun Setup...

**Menu** → **System** → **Setup**

### If You Want to Turn the Store Demo Mode On or Off.

To set or unset **Store Demo** mode outside of **Setup**, press and release the Controller when the power is on. The Function menu screen appears. Push the Controller to the left (to **MENU** (III)) and hold for more than 5 seconds. The **Store Demo** mode is set. To cancel **Store Demo**, bring up the Function menu using the Controller, push the Controller to the right (to **Source** (←)) and hold for more than 5 seconds. See page 12 for information about the Controller.

## Connecting to AV Devices (Blu-ray Players, DVD Players, etc.)

### Using an HDMI Cable for an HD connection (up to 1080p, HD digital signals)

For the best quality HD picture, we recommend using an HDMI connection.

Use with DVD players, Blu-ray players, HD cable boxes, and HD Set-Top-Box satellite receivers.

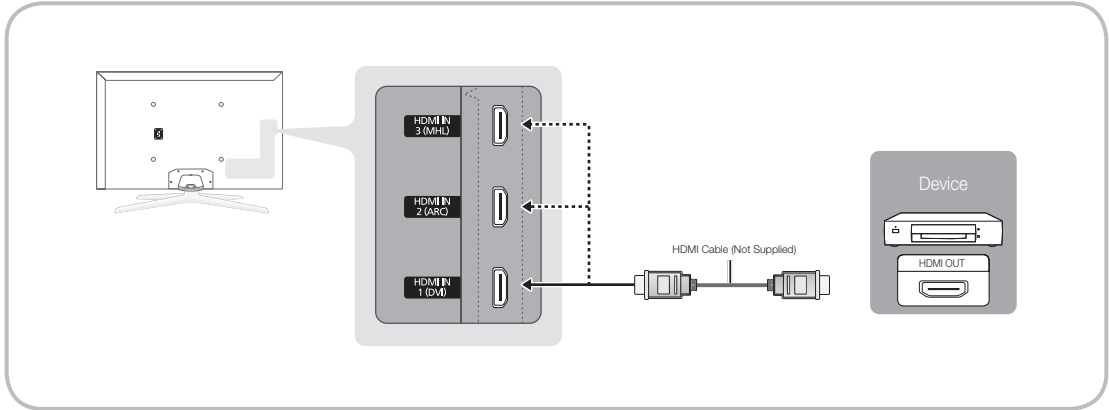

#### HDMI IN 1 (DVI), HDMI IN 2 (ARC), HDMI IN 3 (MHL)

- For the best picture and audio quality, connect digital devices to the TV using HDMI cables.
- An HDMI cable supports digital video and audio signals, and does not require an audio cable.
  - To connect the TV to a digital device that does not support HDMI output, use an HDMI to DVI cable and audio cables.
- If you connect an external device to the TV that uses an older version of HDMI, the video and audio may not work. If this occurs, ask the manufacturer of the device about the HDMI version and, if it is out of date, request an upgrade.
- Be sure to purchase a certified HDMI cable. Otherwise, the picture may not display or a connection error may occur.
- We recommend using a basic high-speed HDMI cable or an HDMI cable that is Ethernet compatible. Note that this product does not support the Ethernet function via HDMI.
- This product supports the 3D and ARC (Audio Return Channel) functions via an HDMI cable. Note that the ARC function is supported by the **HDMI IN 2 (ARC)** port only.
- The ARC function allows digital audio to output via the **HDMI IN 2 (ARC)** port on the TV. It can be enabled only when the TV is connected with an audio receiver that supports the ARC function.

- This product supports the Mobile High-Definition Link (MHL) function via an HDMI-MHL cable. Note that the MHL function is supported by the **HDMI IN 3 (MHL)** port only.
- The MHL function lets you display a mobile device's screen via the **HDMI IN 3 (MHL)** port on the TV. It can be enabled only when the TV is connected with a mobile device that supports the MHL function. For more detailed information, see "Using the MHL function" in e-Manual.
- When you use MHL devices via a MHL cable, **Picture Size** is set to **Screen Fit** automatically. But if you use MHL devices via an HDMI cable, **Picture Size** is not set to **Screen Fit** automatically. To view an original size, select **Screen Fit** in the **Picture Size** menu (**Menu** → **Picture** → **Picture Size**).
- If you use MHL devices via an HDMI cable, The TV will be recognized as the HDMI input. In this case, the TV may work differently than when you use MHL devices via a MHL cable.

🔗 For the best cable connection to this product, use cables no thicker than the cable illustrated below:



### Using a Component Cable (up to 1080p HD signals) or an Audio/Video Cable (480i analog signals only)

Use with DVD players, Blu-ray players, cable boxes, STB satellite receivers, VCRs.

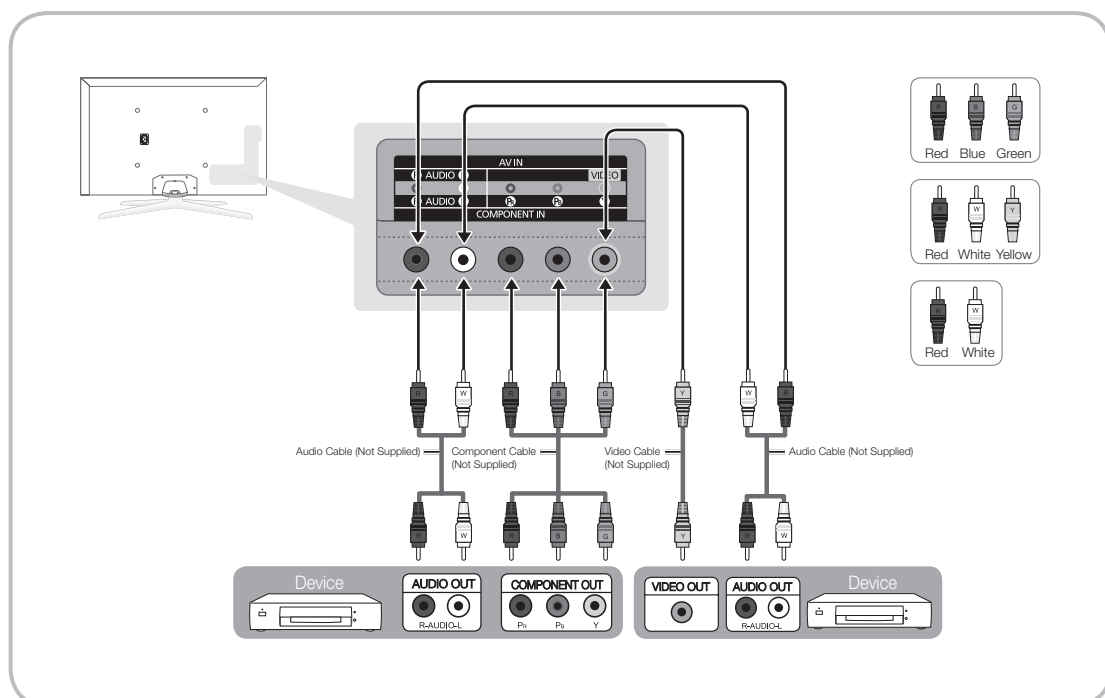

- 🔗 For better picture quality, we recommend the Component connection over the A/V connection.
- 🔗 When you connect a Video cable to **AV IN**, the color of the **AV IN [VIDEO]** jack (green) will not match the video cable (yellow).

## Connecting to Audio Devices

### Using an Optical (Digital) Cable Connection

Use with Digital Audio Systems, Amplifiers, and Home Theaters.

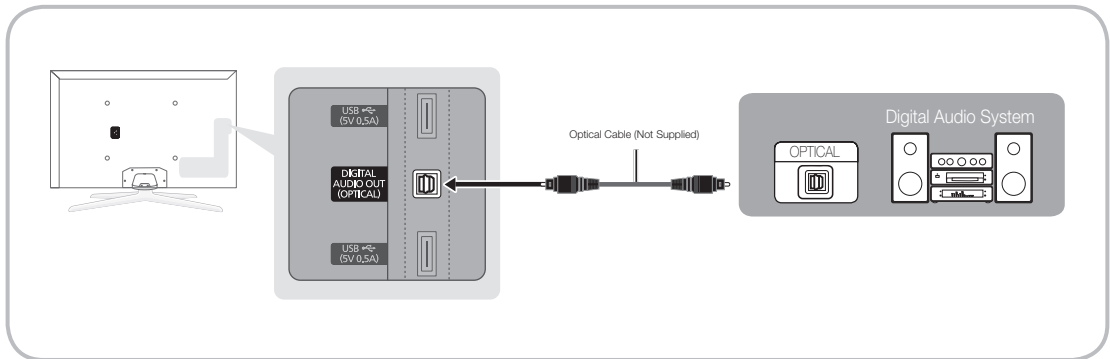

#### DIGITAL AUDIO OUT (OPTICAL)

- When you connect a Digital Audio System to the **DIGITAL AUDIO OUT (OPTICAL)** jack, decrease the volume of both the TV and the system.
- 5.1 CH (channel) audio is available when you connect the TV to an external device supporting 5.1 CH.
- When the receiver (or home theater) is set to on, you can hear sound output from the TV's optical jack. When the TV is receiving a DTV signal, the TV will send 5.1 CH sound to the home theater receiver. When the source is a digital component such as a DVD player / Blu-ray player / cable box / STB (Set-Top-Box) satellite receiver and you connected it to the TV via HDMI, you will only hear 2 CH audio from the home theater receiver. If you want to hear 5.1 CH audio, connect the digital audio out jack from your DVD / Blu-ray player / cable box / STB satellite receiver directly to an amplifier or home theater.

## Connecting to a PC

### Using an HDMI cable or an HDMI to DVI cable

- ✎ Your PC may not support an HDMI connection.
- ✎ Use your PC speakers for audio.

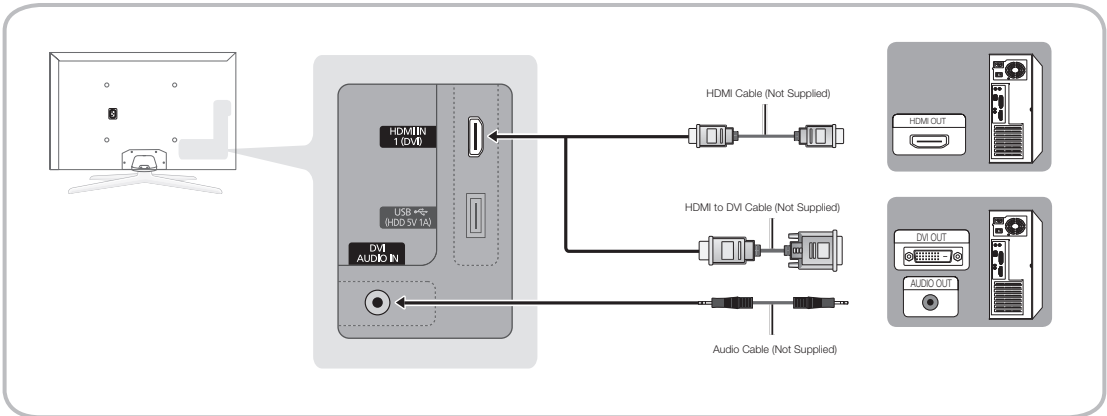

The optimal resolution is 1920 X 1080 @ 60 Hz. See the Display Resolution page for all available resolutions (page 58).

#### NOTE

- For an HDMI to DVI cable connection, you must use the **HDMI IN 1 (DVI)** jack.
- For PCs with DVI video out jacks, use an HDMI to DVI cable to connect the DVI out on the PC to the **HDMI IN 1 (DVI)** jack on the TV. Use the PC's speakers for audio.
- PC (D-Sub) input is not supported.

## The EX-Link Cable Connection

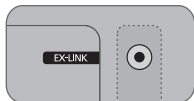

The EX-LINK connection is for service only.





### Source

 → **Source**

When you are watching TV and you want to watch a movie on your DVD player or Blu-ray player or switch to your cable box or STB satellite receiver, you need to change the Source.

#### ■ TV / HDMI1/DVI / HDMI2 / HDMI3 / AV / Component

1. Press the  button on your remote. The **Smart Hub** screen appears.
2. Select **Source**. The **Source** screen appears.
3. Select a desired external input source.

 Alternatively, you can access the **Source** screen by selecting the **SOURCE**  button on your standard remote or selecting **Source** with the Smart Touch Control (see page 39).

 You can only choose external devices that are connected to the TV. In the displayed **Source** list, connected inputs are highlighted.

### How to Use Edit Name

**Edit Name** lets you associate a device name to an input source. To access **Edit Name**, open the **Tools** menu when the **Source** list is displayed. The following selections appear under **Edit Name**:

■ **VCR / DVD / Cable STB / Satellite STB / PVR STB / AV Receiver / Game / Camcorder / PC / DVI PC / DVI Devices / TV / IPTV / Blu-ray / HD DVD / DMA**: Select an input jack, and then select the name of the device connected to that jack from the list that appears. For example, if you have your Blu-ray player attached to **HDMI IN 2 (ARC)**, select **Blu-ray** for that input.

 If you connect a PC to the **HDMI IN 1 (DVI)** port with an HDMI cable, assign **PC** to **HDMI1/DVI** in **Edit Name**.

 If you connect a PC to the **HDMI IN 1 (DVI)** port with an HDMI to DVI cable, assign **DVI PC** to **HDMI1/DVI** in **Edit Name**.

 If you connect an AV device to the **HDMI IN 1 (DVI)** port with an HDMI to DVI cable, assign **DVI Devices** to **HDMI1/DVI** in **Edit Name**.

### Information

You can see detailed information about the selected external device.

### Refresh

If the external devices are not displayed in the **Source** list, open the **Tools** menu, select **Refresh**, and then search for the connected devices.

 Alternatively, you can refresh the **Source** list by selecting  using your remote.

## Using Smart Hub

Smart Hub provides easy, on-screen access to five functions that let you manage and access channels, set favorite channels, access photos, videos, or music on USB devices, cameras, and PCs, select video sources, and set the TV to turn on automatically when a show you want to watch is on. The five functions are listed below:

- **Channel:** Lets you manage channels, select favorite channels, add channels to and delete channels from the **Added Ch.** list (the channels that appear when you press the **▼ CH ▲** button.)
- **Web Browser:** Lets you browse the Internet.
- **Schedule Manager:** Lets you schedule shows and channels for viewing.
- **Source:** Lets you select a connected external video source to view.
- **AllShare Play:** Lets you access, view, or play photos, videos, or music located on USB devices, digital cameras, cell phones, and PCs. PCs and cell phones can be accessed wirelessly, through your wireless network.

**Smart Hub** also provides an easy-to-use gateway to a host of on-line media and entertainment including apps from the Samsung Apps store, streaming videos and movies, kids sites, and more.

 To access **Smart Hub**, press the  button on your remote.

 For more information about **Smart Hub**, see the e-Manual.

Using this function, you can access and control menu options and functions using speech, motions or face recognition.

### INFORMATION BOOKLET DISCLAIMER

- **Face recognition Log-in**

In order for **Face recognition** to function, a thumbnail image of your face will be stored in your TV for logging-in purposes.

Logging into the **Smart Hub** using **Face recognition** may be less secure than using an ID and password.

- **TV Camera Usage**





Before using the TV Camera, you should be aware that under some circumstances and under certain legal conditions your misuse of the TV Camera can result in legal liability for you. By using the TV Camera, you agree that you will not use the camera (i) in locations where cameras are generally prohibited (such as bathrooms, locker rooms or changing rooms), (ii) in any manner that will result in an invasion of a person's privacy or (iii) in violation of any applicable laws, regulations or statutes.

When you use a TV camera, you should check whether a tape attached or not in rear of the TV camera, and then you can use a TV camera after adjust a camera angle. When you don't want to use a TV camera, we recommend to use after a camera lens fixes to upwards. In this case, **Face recognition** and **Voice and Motion Control** are not available.

## Voice Control







### Menu → System → Voice and Motion Control → Voice Control

Enable or disable the voice recognition function. Lets you access and control menu options and functions by speaking letters or words.

-  For accurate voice recognition, refer to the Standard Voice Command list at the Samsung web site ([www.samsung.com](http://www.samsung.com) → support → Manuals & Downloads).
-  **Voice Control** function can be affected recognition by unclear pronunciation, voice level, or surrounding noise.
-  To use **Voice Control**, you must pronounce words and phrases clearly and correctly in the language you selected in **Language**.
-  Ambient noise may cause **Voice Control** to malfunction. (Appropriate surrounding noise: Below 40dB)



Your TV can "hear" your voice commands in two ways:

- Using the TV's microphone. (Distant Recognition)
  -  We are recommended using **Voice Control** function within about 13 ft with your TV. You can check the usable distance by using **Voice Control Environment Test (System → Voice and Motion Control → Voice Control → Voice Control Environment Test)**.

- Using the **VOICE**  button on your remote. (Close Proximity Recognition)
  -  When you use the TV's microphone, the words may not be recognized because of ambient noise. If this occurs, try using the **VOICE**  button on your remote. The TV will be able to recognize a voice command more easily.
  -  The **VOICE**  button on your remote is always activated. If you want to use the TV's microphone, turn on **Voice Control (System → Voice and Motion Control → Voice Control)**.
  -  Say a voice command to proper volume into the microphone of your remote within 0.3 – 0.4 ft. If voice level is too small or large, voice command may not be recognized.
-  If a menu option or function is not supported by the **Voice Control** function, we suggest trying the **Motion Control** function. To use the **Motion Control**, raise your hand while opening it toward the screen, hold it for a moment and then wave it 3 – 4 time to the left and right. **Motion Control** starts. If the **Motion Control** starts, the cursor is displayed at the center of the screen and the **Motion Guide Bar Size** is at the bottom of the screen.

#### ■ **Voice Control**

Turns the **Voice Control** function on or off.

-  The **VOICE**  button on your remote is always activated.

#### ■ **Language**

Select the recognition language you want to use.

#### ■ **Trigger Words**

You can select the **Trigger Words** that start the **Voice Control** function.

Alternatively you can turn on your TV using the **Trigger Words** if **Voice Control** function is set to **On**.

- If the **Trigger Words** is set to **Hi TV**, say **Hi TV Power On**.
- If the **Trigger Words** is set to **Smart TV**, say **Smart TV Power On**.

#### ■ **Voice Command Bar Size**

Set the **Voice Command Bar Size** mode to **Minimum** or **Full**. **Minimum** displays the least number of words and phrases you can use. **Full** displays all the words and phrases.

#### ■ **Voice Sensitivity**

You can configure the sensitivity of Voice recognition.

- **Howling**: Select howling levels.
- **Recognition responsiveness**: Select the responsiveness level of Voice recognition.

## ■ Voice Control Environment Test

You can test the amount of ambient noise level detected by the TV microphone.

- **Noise Test:** This test checks the amount of ambient noise detected by the TV microphone. Too much ambient noise will prevent Voice Command from functioning. To run, select **Next** using your remote. The test starts and takes a few seconds. Please keep as quiet as possible during the test.
- **Mic & Speaker Test:** Determines if the sound from the TV speakers picked up by the TV microphone will disrupt Voice Command. To run, select **Start** using your remote. The test starts and takes a few seconds. Please keep as quiet as possible during the test.
  - 📎 Available only when **Speaker Select** is set to **TV Speaker**.
- **Voice Control Test:** This test checks the volume level and clarity of your voice for use with **Voice Control**. Select **Start** using your remote. After the test starts, say the test words listed in the instructions as loudly and clearly as you can.
  - 📎 If the test is not successful, select **Retest**, and then say the words loudly and clearly again.

### To use the Voice Control function, follow these steps:

- 📎 If **Voice Control** function is set to **On**, the TV may be turned on automatically by effect of the ambient environment.
1. Speak the **Trigger Words** that you selected into the microphone embedded in the TV or press the **VOICE** button on your remote. The TV displays the **Voice Command Bar Size**.
    - 📎 When you use the **Voice Control**, the volume is set to 5 automatically.
  2. Say a word or phrase listed in the **Voice Command Bar Size**.
    - 📎 Pronounce the word or phrase clearly and correctly in the language you selected in **Language**.
  3. Wait until recognition is complete, and then say the next command in the same fashion.
    - 📎 To exit the **Voice Control** mode, speak the **Trigger Words** or "Cancel" using the TV's microphone, or press the **RETURN** button.





### Using the Voice Text Input Mode

1. Say "Search All" while in the **Voice Control** mode.
    - 📎 When you use a **QWERTY** keypad screen, you can use the Voice Text Input Mode. Say the **Trigger Words** that you selected into the microphone embedded in the TV or press the **VOICE** button on your remote. You cannot use it for some UIs such as URL input boxes.
  2. Say the word or phrase you wish to search for.
  3. The TV executes the spoken function.
- 📎 Voice Control performance levels will vary based on the language spoken.

# Motion Control

Menu → System → Voice and Motion Control → Motion Control

Enable or disable the **Motion Control** function. Lets you control your TV by moving the TV cursor using specific motions.

-  **Motion Control** function can be affected recognition by motion posture, or ambient brightness conditions.
-  Some applications may not support **Motion Control**.
-  You may experience physical fatigue when you use the **Motion Control** for a long time.
-  To use the **Motion Control**, please avoid direct sunlight.
-  We are recommended using **Motion Control** function within about 5 – 13 ft with your TV. TV Camera's recognition range may differ depending on the angle of camera or other conditions. You can check the recognition range of TV camera by using **Motion Control Environment Test (System → Voice and Motion Control → Motion Control → Motion Control Environment Test)**.

## ■ Motion Control



Turns the **Motion Control** function on or off.

## ■ Motion Guide Bar Size



Set the **Motion Guide Bar Size** mode between **Minimum** or **Full**.

## ■ Motion Control Environment Test

You can test the brightness of room and the camera angle.

- **Brightness Test:** This test checks to see if your room is bright enough for **Motion Control** to work properly. Select **Start** using your remote. The test will start and should take only a few seconds. (Appropriate ambient brightness: 50 – 500 Lux)
  -  Do not illuminate a sunlight or lights directly into the camera lens.
  -  Make sure that the camera lens is cloaked by an object.
- **Camera Angle Test:** On the **Camera Angle Test** screen, select **Start** using your remote. A rectangle appears on the screen. Move yourself into the rectangle by adjusting the camera or moving yourself in front of the camera. If you are not within the rectangle position, the test may not work properly. After aligning your body with the TV, raise your hand while opening it toward the screen, hold it for a moment and then wave it 3 – 4 times to the left and right.

## To use the Motion Control function, follow these steps:

1. To use the **Motion Control**, raise your hand while opening it toward the screen, hold it for a moment and then wave it 3 – 4 times to the left and right. **Motion Control** starts. If the **Motion Control** starts, the cursor is displayed at the center of the screen and the **Motion Guide Bar Size** is at the bottom of the screen.
  2. Control the TV using your hands.
-  Note that the **Motion Control** function closes if your hands go out of the camera range.
  -  While using the **Motion Control**, if you use the other devices (i.e. remote control, keyboard, etc.), **Motion Control** closes.

## Controlling the TV with your hands using motions

### ■ **Access Motion Control**

- **Action:** Spread your hand in the direction of the camera, and shake it three or four times from a side to side.

### ■ **Pointing Navigation**

Moves the cursor to the position you want.

- **Action:** Spread your hand and guide the cursor to position you want.

### ■ **Run**

Selects an item or executes a command that is indicated by the cursor or is highlighted.

- **Action:** Clench your fist.

 When you watch some page or some image, you can move the page or image to direction you want if it can be moved. In this case, use and keep the **Run** motion, and then move it to direction you want. To move a page, clench your fist, keep it clenched, and then move it in the direction you want the page to move. Note that not all pages can be moved.

### ■ **Return**

Return to the previous menu.

- **Action:** Spread your hand and rotate it counterclockwise.

### ■ **Channel / Volume Control**

Changes the channel or adjust the volume.

 If you use the **Motion Control** function while watching a channel, the channel / volume control screen appears.

- **Action:** Use the **Pointing Navigation** motion to move the cursor to the channel or volume controller, and then uses the **Run** motion to adjust the channel or volume.

 If you use the **Run** motion once, it has the same effect as pressing a button on your remote. If you hold the **Run** motion, it has the same effect as pressing and holding a button on your remote.

### ■ **Scroll**

Scroll the page in the direction you want. For example, suppose that you want to scroll down.

 Some applications may not support this function.

1. Move the cursor to the bottom of the screen (page scroll zone) using the **Pointing Navigation** motion.
2. Move the cursor to the center of the screen using the **Pointing Navigation** motion.
3. The page will move down.

## Face recognition

 → **Tools** → **Settings** → **Account Manager** → **Face recognition**

Enable or disable the Face recognition function. Face recognition lets you register your face with your Samsung account. Also, you can log in to the Samsung account using the **Face recognition** function without inputting your account ID or your account password.

 You can register your face in only one account.

### To register your face in your Samsung account, follow these steps:

-  To use this function, you must log into **Smart Hub**. If you don't have a **Samsung Account**, you should create one before using this function. To create your **Samsung Account**, refer to "Creating an Account" (Advanced Features → Smart Hub) in the e-Manual.
1. On the **Smart Hub** screen, open the **Tools** menu using your remote, and then select **Settings**.
  2. Select **Account Manager**. The **Account Manager** screen appears.
  3. Select **Face recognition**. The **Face recognition** screen appears.
  4. Move your face into the square in the center of the screen, and then wait until the square changes from red to green.

 If **Face recognition** fails, select **Retry** and then try again.
  5. When done, your face is now registered in your Samsung account. The Continue to Register Service window appears.

 To close the window, select **OK**. You can register services later using **Link to other accounts** in the **Smart Hub** menu (**Settings** → **Account Manager** → **Link to other accounts**).



## To log in to your Samsung account using Face recognition, follow these steps:

 If you use **Face recognition** to log into **Smart Hub**, it may be less secure than logging in with a password.

1. With the **Smart Hub** screen displayed, select **A** using your remote. The **Samsung Account** screen appears.



2. Select **Face Recognition Mode**. The **Face recognition** screen appears.

 To return to the **Samsung Account** screen, select **Password mode**.

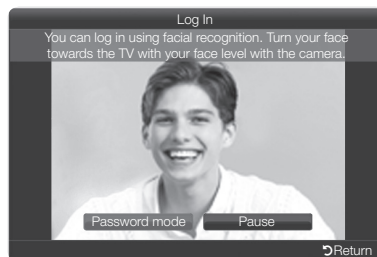



3. The TV starts **Face recognition**. Face the front of the TV screen. The TV will recognize your face automatically.

 A Green square indicates a registered face. A red-square indicates an unregistered face.

 If the TV fails to recognize your face, try again.

4. The TV logs you into your Samsung account automatically.

 If the TV recognizes two or more registered faces, the Samsung account list appears. Select your account to log in.

 If your face is unregistered, you can register your face in your Samsung account. Follow steps 4 through 5 in the “To register your face to your Samsung account:” procedure above.

 If you have no account, you can create one. For more detailed information, refer to “Creating an Account” (Advanced Features → Smart Hub) in the e-Manual.

## The Evolution Kit Slot (Kit Sold Separately)

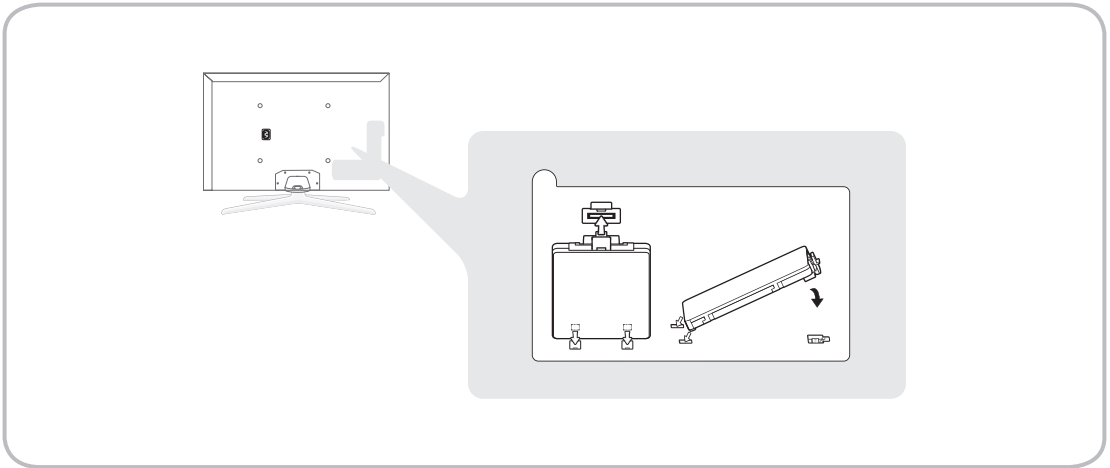

This socket is designed to accept an extension device called the Evolution Kit. The Evolution Kit enables the TV to run a variety of the latest applications for a better user experience.

The Evolution Kit, which may not be available depending on the product, will be sold separately in 2013 or later.

## Connecting to a Network

You can set up your TV so that it can access SMART TV applications through your local area network (LAN) using a wired or wireless connection.

After you have “physically” connected your TV to your network, you must configure the network connection to complete the process. You can configure the connection during the Initial Setup process (see page 17) or after the Initial Setup process, through the TV’s menu (see page 37).

### Network Connection - Wireless

You can connect your TV to your local area network (LAN) through a standard wireless router or modem.

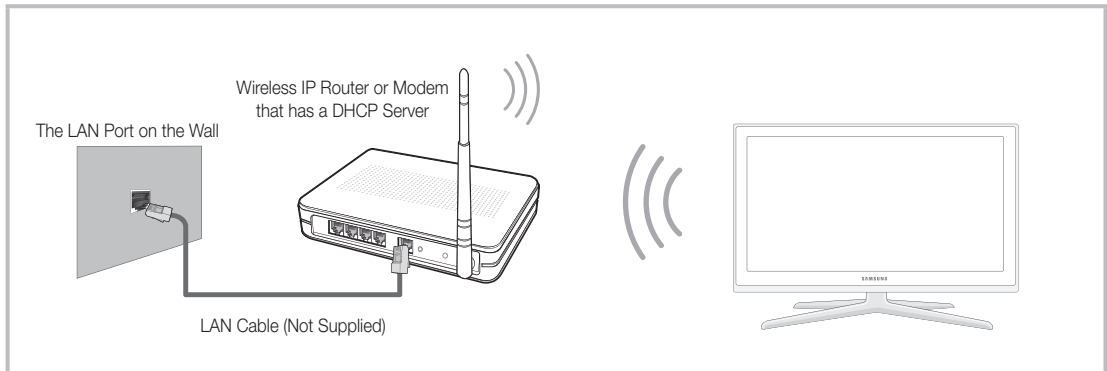

This TV supports the IEEE 802.11a/b/g and n communication protocols. Samsung recommends using IEEE 802.11n. If you play video using IEEE 802.11a, b, or g, the video may not play smoothly.

Most wireless network systems incorporate a security system that requires devices that access the network through an access point or AP (typically a wireless router or modem) to transmit an encrypted security code called an access key.

Your TV is compatible with the following security protocols:

- Authentication Mode: OPEN, SHARED, WPAPSK, WPA2PSK
- Encryption Type: WEP, TKIP, AES

If you select Pure High-throughput (Greenfield) 802.11n mode and the Encryption type is set to WEP or TKIP on your AP or wireless router, Samsung TVs will not support a connection in compliance with new Wi-Fi certification specifications.

## Network Connection - Wired

There are three main ways to connect your TV to your network using cable, depending on your network setup. They are illustrated starting below:

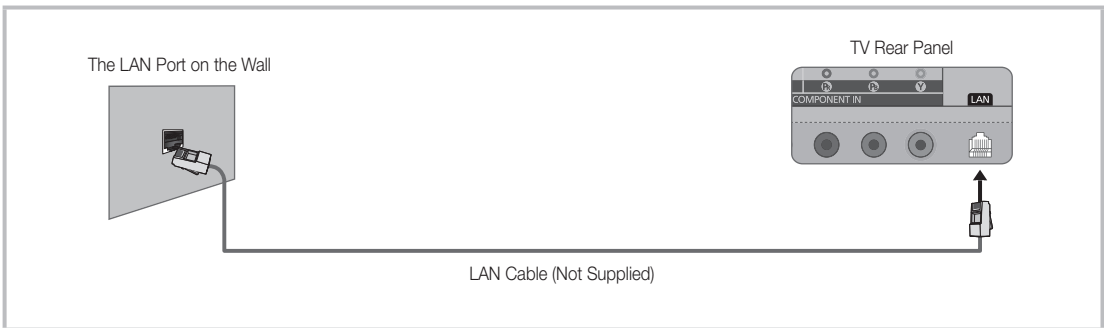
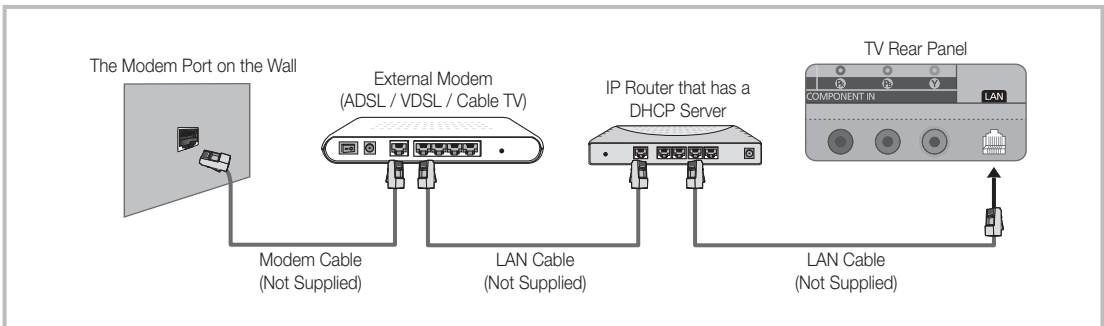
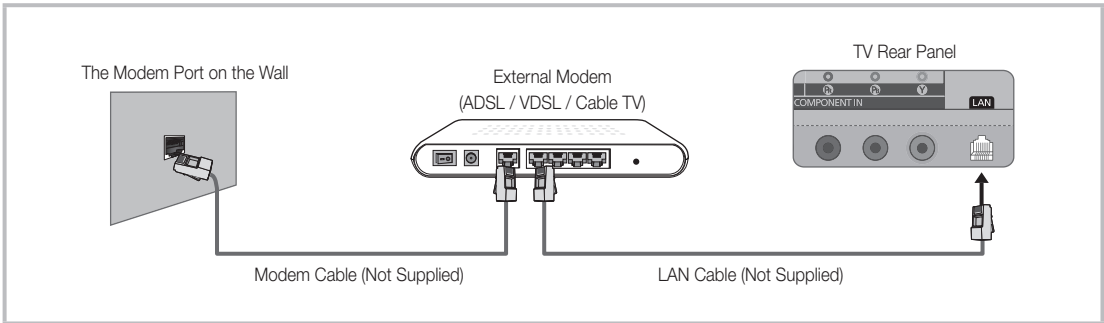

- 📎 The TV does not support network speeds less than or equal to 10Mbps.
- 📎 Use Cat 5 or 6 (STP Type\*) cable for the connection. (\*Shielded Twisted Pair)

## Configuring Network Connections

After you have run the initial setup, you can configure or reconfigure the network connections through the TV's menu.

### Configuring a Wireless Network Connection

The instructions below are for networks that use the Dynamic Host Configuration Protocol (DHCP) to configure network connections automatically. Most wireless networks use DHCP. If you have a Static IP network, see the e-Manual for configuration instructions.



To configure the network connection for a network that uses DHCP, follow these steps:

1. Connect your TV to your network as shown in the illustration on page 35.
2. Turn on your TV, and then go to the **Network Settings** screen. (**Menu** → **Network** → **Network Settings**)
3. Select **Start**. The Network function searches for available wireless networks. When done, it displays a list of the available networks.
4. In the list of networks, move the highlight to select a network, and then select **Next**.
  - ✎ If you have a WPS(PBC) compatible router, select **WPS(PBC)** instead, and then follow the directions on the screen.
5. Enter your network security key or WPS PIN using your remote.
  - ✎ Enter numbers and letters using your remote.
    - If you are using the standard remote, you can enter numbers by pressing the number buttons on your remote.
    - To enter a letter, move the Highlight to the letter, and then select it. You can enter numbers in the same fashion if you choose.
  - ✎ To display capital letters (or redisplay small letters if capital letters are displayed), select **Caps** or **Shift**.
  - ✎ To display symbols and punctuation, select 1★. To redisplay letters, select 1★ again.
6. When done, select **Next** if you have entered a security key or **WPS PIN** if you have entered a WPS PIN.
7. The TV checks the wireless connection. If the connection is successful, the “**You are connected to the Internet. If you have any problems using online services, please contact your Internet Service Provider.**” message appears. Select **Next** using your remote.
  - ✎ For more detailed information, see “Setting up the Wireless Network” in the e-Manual.
  - ✎ If you want to configure the connection manually, select **IP Settings** on the Network Connection screen. Set **IP Setting** to **Enter manually**, and then enter the **IP Address**, **Subnet Mask**, **Gateway**, and **DNS Server** manually.

## Configuring a Wired Network Connection

Most home networks use the Dynamic Host Configuration Protocol (DHCP) to configure network connections. Home networks that support DHCP automatically provide the IP address, subnet mask, gateway, and DNS values your TV needs to access the Internet so you don't have to enter them manually. If you have a Static IP network, see your user's manual for configuration instructions.

To configure the network connection for a wired network that uses DHCP, follow these steps:

1. Connect your TV to your network as shown in one of the illustrations on page 36.
  2. Turn on your TV, and then go to the **Network Settings** screen. (**Menu** → **Network** → **Network Settings**)
  3. Select **Start**.
  4. The Network Connection screen appears, and verifies the network connection. When the connection has been verified, the **"You are connected to the Internet. If you have any problems using online services, please contact your Internet Service Provider."** message appears. Network set up is completed.
-  If your TV cannot acquire network the connection values automatically or if you want to set the connection manually, select **IP Settings** on the network connection screen. Set **IP Setting** to **Enter manually**, and then enter the **IP Address**, **Subnet Mask**, **Gateway**, and **DNS Server** manually.
-  For more detailed information, refer to "Setting up the Wired Network" in the e-Manual.



## Installing batteries (Battery size : AA)

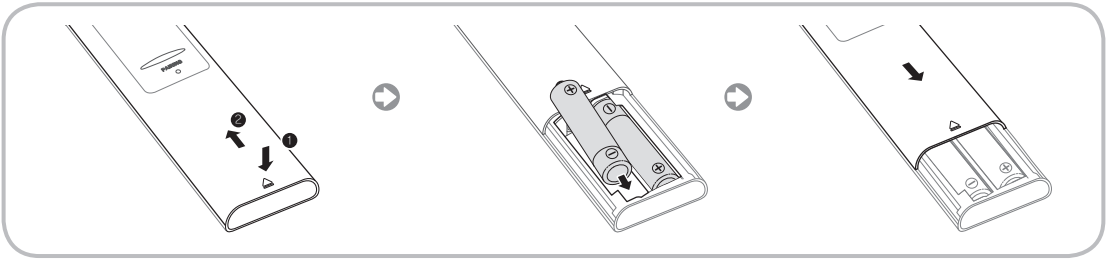

1. Press the back of the remote at the very bottom with both thumbs, and then slide the battery cover up in the direction of the arrow.
2. Install two batteries so that the polarity of the batteries (+/-) matches the illustration in the battery compartment.
3. Slide the cover down in the direction of the arrow to close the battery cover.

## Initial Pairing for Smart Touch Control

After you have run the Initial Setup on your TV, you should connect your Smart Touch Control to your TV.

1. Point the Smart Touch Control toward the IR sensor of the TV and then press any button on the Smart Touch Control.
2. The connection icon appears at the bottom left of the screen and the Smart Touch Control is automatically connected to the TV.

📌 If you want to perform the pairing process again, press the reset button in the center of the back cover using a pin or the tip of an unbent paper clip. The Smart Touch Control will be initialized.

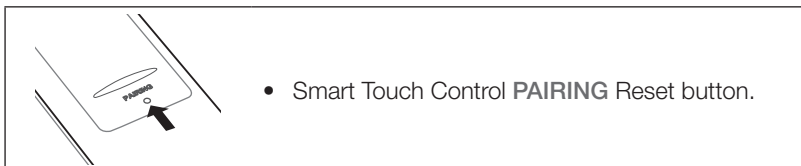

## Calibrating the Touch Pad

To calibrate the Touch Pad on the Smart Touch Control, follow these steps:

1. Press the **NUMBER** button for 3 seconds. The calibration starts.
2. When done, all the LEDs on the top of the Smart Touch Control blink twice simultaneously.

📌 While calibrating, don't touch the Touch Pad.

📌 If the Touch Pad loses accuracy, re-calibrate the Touch Pad by repeating Steps 1 and 2.



## Using the Touch Pad

To display the shortcut functions list on the bottom of the screen, press the  button at the bottom of the Touch Pad. This list includes **Menu**, **Source**, **Ch List**, **3D**, **Support**, and a number of other functions.

To display the color and playing control functions on the top of the screen, press the  button on the top of the Touch Pad.

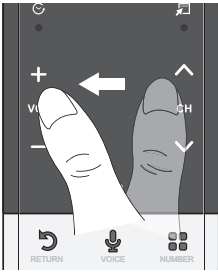

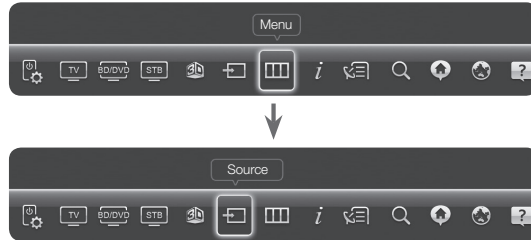

**To Move the Highlight:** Rest your finger on the Touch Pad, and then slide it from one side to the other, from top to bottom, or bottom to top.

 To move the Highlight continuously, flick your finger across the Touch Pad from right to left, left to right, top to bottom, or bottom to top.

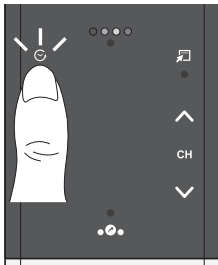

**To Select an item:** Press the Touch Pad.



**Open the History screen.:** Press the  button in the left of the Touch Pad. Displays a list of recently used functions. You can select a function again using the Touch Pad easily and quickly.

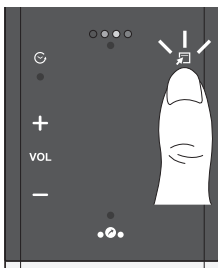

**Open the Tools menu.:** Press the  button in the right of the Touch Pad. Quickly select frequently used functions.

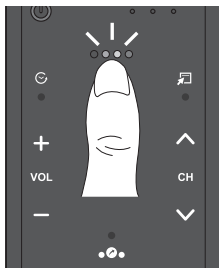

**Open the color, playing control and exit buttons.:** To display the color, exit and play control buttons at the top of the screen, press the ●●●● button at the top of the Touch Pad.



→ [Close]: Close all menus shown on the screen.

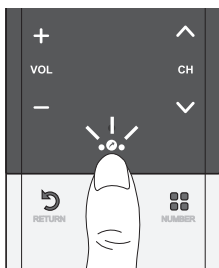

**Open the shortcut functions screen.:** Press the ●●● button in the bottom center of the Touch Pad. You can select a desired function (e.g. **Menu** (≡), **Source** (⊞), **Info** (i), etc.) easily.



### Using the Mute function

- If you press and hold the Touch Pad, it has same effect as pressing the **MUTE** (≡) button on your remote.
- However, if you press and hold the touch pad when using **Web Browser**, the Touch Pad switches to the Scroll mode. When you press the Touch Pad again, the Scroll mode switches general mode.
- Press the Touch Pad or **RETURN** (↶) button to return to the general mode.

### To Enter a channel number through Smart Touch Control

1. While watching a broadcast, press the **NUMBER** (≡) button on the Smart Touch Control. The TV displays the number button screen.
  2. Using the Touch Pad, highlight a number, and then press the Touch Pad. The TV displays a list of channels that start with the number you selected.
  3. Using the Touch Pad, highlight the channel in the list you want, and then press the Touch Pad.
- ✎ You can also change the channel by touching the up or down channel icon on the Touch Pad. If you touch the Touch Pad immediately after, the TV displays the list of memorized channels. Select a channel by moving or flicking your finger up or down, and then pressing the Touch Pad.
- ✎ If you change a channel by entering the channel number, that channel number is memorized and added to the **Added Ch.** list automatically. You can change channels using the memorized channel list easily and quickly.

## The IR Blaster

When you connect an IR Blaster with your TV, you can control connected external devices with your TV using the Smart Touch Control.

- ✎ If you control an external device by using the Smart Touch Control, the IR Blaster sends an IR signal into a corresponding external device.
- ✎ Install the IR Blaster within 50 cm and 45 degrees of the up, down, left and right directions of the IR sensor of the external device.

### IR Blaster

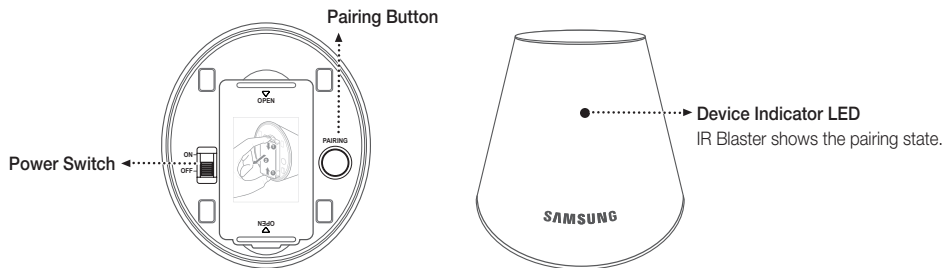

### Installing batteries (Battery size : AA)

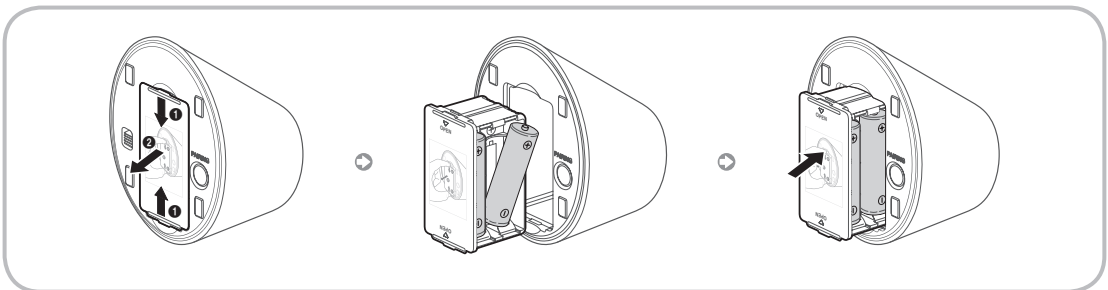

1. Hold the both sides of the battery holder and pull it out.
2. Install four batteries so that the polarity of the batteries (+/-) matches the illustration in the battery compartment.
3. Push it back.

## IR Blaster Pairing

1. When you turn the IR Blaster on, the LED blinks.
  2. Briefly point the IR Blaster toward the IR sensor of the TV and press the **PAIRING** button at the bottom.
  3. The connection icons appear on the bottom left of the screen, and the TV connects to IR Blaster automatically.
-  If the connection process failed, please turn off and on the IR Blaster, try again from step 2.



-  To set an Universal Remote Control after pairing an IR Blaster, select **Yes**.

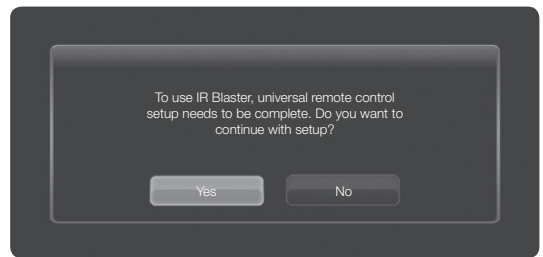



## **Precautions for Using an IR Blaster**

To use an IR Blaster, the IR Blaster must be located nearby with external devices connected to the TV. Note that it should be no obstacle between the external device's IR receiver and an IR Blaster.

## Setting up the Universal Remote Control

Lets you control a Set-Top-Box (STB) or a BD player or both connected to the TV using your Smart Touch Control. After you connect the device to the TV, the Smart Touch Control can control the navigation, number, and other keys needed to operate and control the device.

-  The Universal Remote Control can adjust TV's volume, but STB's volume cannot be adjusted. Watch STB after adjusting STB's volume to appropriate level.
-  Depending on the version of an application, the **Universal Remote Setup** instructions may differ. In this case, please follow the instructions on the screen.

### To connect the external device to your Smart Touch Control, follow these steps:

1. Select **Add a device to control**, and then press the Touch Pad.

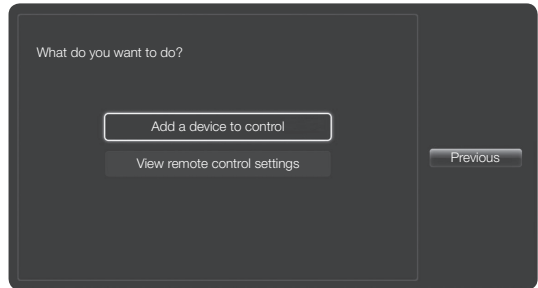

2. Select an external device from the connected devices, and then press the Touch Pad.

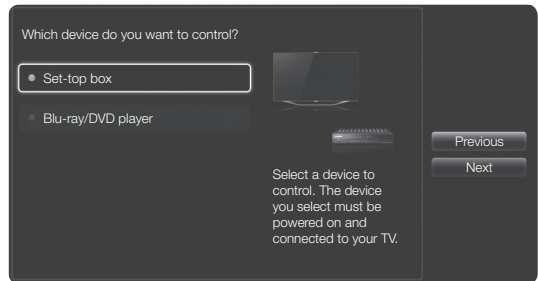

3. Select the port used to connect the external device, and then press the Touch Pad.

-  Make sure that the selected device is on. If it is turned off, turn the power on and press **Refresh**.

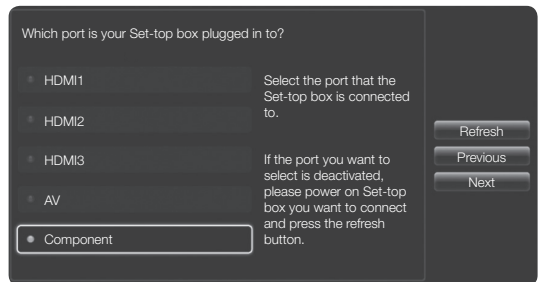

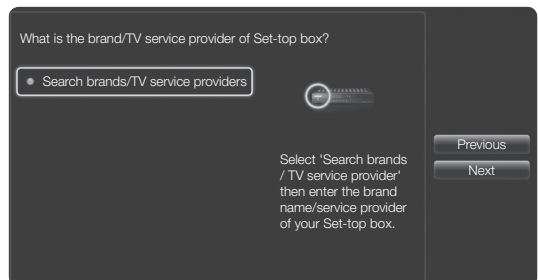

4. Select **Search brands/TV service providers**, and then press the Touch Pad. A keyboard and an entry field appear. Enter the first few letters of the brand name of your device using the Smart Touch Control, and then select **Done** at the bottom of the keyboard. In the list that appears below the entry field, select the brand name of your device, and then press the Touch Pad.

-  If you want to search the brand of STB (Set-Top box), you can search the STB by using the brand name or a cable provider.





5. Select **Search Model**, and then press the Touch Pad. A keyboard and an entry field appear. Enter the first few letters and numbers of the model name of your device using the Touch Control, and then select **Done** at the bottom of the keyboard. In the list that appears below the entry field, select the model name of your device, and then press the Touch Pad.

 If the search for model name does not work properly, search with a part of the model name or use the search for recommended model code.

 For more information on the search for recommended model code function, refer to page 47.

6. Select **Download**, and then press the Touch Pad. Download the configuration data for the IR Blaster in the same way.

7. When all the settings are complete, select the **Complete** button and press the Touch Pad.

 To reset IR Blaster and Smart Touch Control, press the  button on Smart Touch Control, and then select **Universal Remote Setup** .

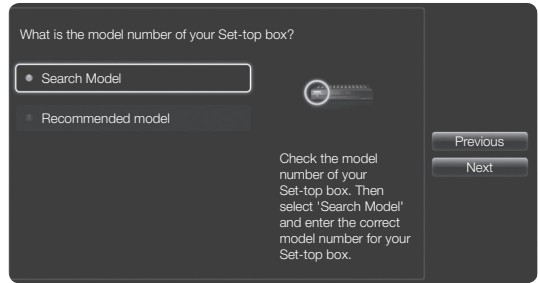

## Using the Search for Recommended Model Code

1. In the **Search Model** step in the integrated remote control setup, select the **Recommended model** and press the Touch Pad.

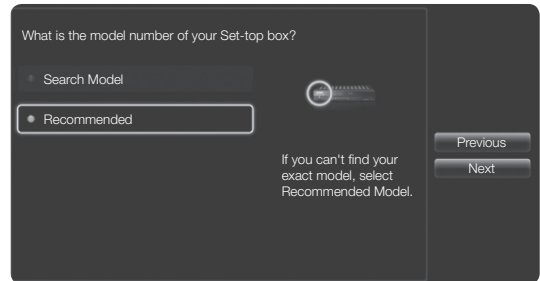

2. Select **Download** to download the recommended model code.



3. Point the Smart Touch Control forward to the IR sensor of the external device and then press the Touch Pad to test if the device works.

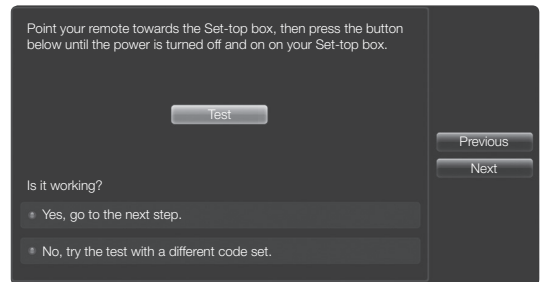

4. If the downloaded recommended model code does not work, repeat the steps from step 3.

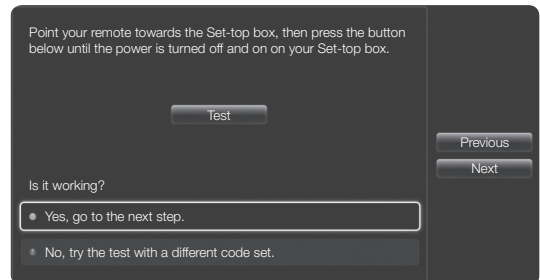

 When you use the BD home theater by using Universal Remote, some buttons may not be supported. In this case, we recommend to use **Anynet+ (HDMI-CEC)** function.

# How to view the e-Manual

You can find instructions for your TV's features in the e-Manual. To open the e-Manual, press the **SUPPORT** button on your standard remote or select **Support** using the Smart Touch Control.

You can also access it through the menu:

**Menu** → **Support** → **e-Manual**

## Access the e-Manual

To use the e-Manual, follow these steps:

1. When you need help, select **Support** using your remote. The **Support** screen appears.
  2. Select **e-Manual** using your remote. The **e-Manual** screen appears.
  3. Select a desired category.
  4. Select a desired topic. The e-Manual displays the page you want to see.
- 📎 Blue words in e-Manual signify menu options or selections on TV screen.
  - 📎 Green icons in the e-Manual signify a button on your remote.
  - 📎 Arrow steps (e.g. **Menu** → **Support** → **e-Manual**) in the e-Manual signify the sequence of steps required to access an option or activate a function.

## How to toggle between an e-Manual topic and the corresponding OSD menu(s).

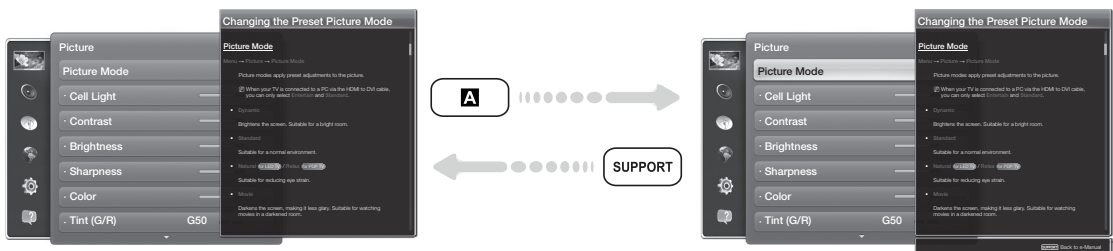

- 📎 This function is not enabled in some menus.
  - 📎 You can't use the **Try Now** function if the menu is not available.
1. To go to the topic's corresponding menu option, select **A** using your remote.
  2. To return to the e-Manual screen, select **Support** using your remote.



## Using the colored and function buttons with the e-Manual

- **Scroll bar:** Scroll the e-Manual screen up or down.
- **◀/▶:** Moves to the previous or next chapter.
- **A Try Now:** Move to the OSD menu that corresponds to the topic. To return to the e-Manual screen, select **Support** using your remote.
- **B Home:** Moves to the e-Manual home screen.
- **C Position:** Each time you select **C**, you change the position of the e-Manual screen.
- **D Index:** Displays the Index screen.
- **↶ Return:** Return to the previous screen.

## How to search for a topic on the index page

1. Select **D** using your remote. The Index screen appears.
2. To search for a topic, select a letter. The Index displays a list of topics and keywords that begin with the letter you selected.
3. Select a topic or keyword you want.
4. The e-Manual page with the topic appears.
  - 📎 To close the **Index** screen, press the **RETURN** **↶** button.

## To Change the screen position of the e-Manual

If the e-Manual screen is not invisible well because the OSD Menus screen, you can change the e-Manual screen's position.

1. Move the Highlight to the e-Manual screen by pressing the **SUPPORT** button on your standard remote or select **Support** using the Smart Touch Control.
2. Press the **C** button on your standard remote, or select **C** using the Smart Touch Control. Each time you select **C**, the position of the e-Manual will change.

## Troubleshooting

If the TV seems to have a problem, first review this list of possible problems and solution. Also review the Troubleshooting Section in the e-Manual. If none of the troubleshooting tips apply, visit [www.samsung.com/support](http://www.samsung.com/support) or call Samsung Customer Service at 1-800-SAMSUNG (1-800-726-7864).

Issues	Solutions and Explanations
Flickering and Dimming	<p>If your Samsung Television is flickering or dimming sporadically, you may need to disable some of its energy efficient features such as the <b>Eco Sensor</b> or the <b>Energy Saving</b> feature. Follow the steps below with your remote to turn these features off or on.</p> <ul style="list-style-type: none"> <li>• <b>Energy Saving: User Menu → System → Eco Solution → Energy Saving</b></li> <li>• <b>Eco Sensor: User Menu → System → Eco Solution → Eco Sensor</b></li> </ul>
Component Connections / Screen Color	<p>If you find that the color on your Samsung television's screen is not correct or black and white, first run a <b>Self Diagnosis</b> on the TV to make sure there are no device issues.</p> <ul style="list-style-type: none"> <li>• <b>Self Diagnosis: User Menu → Support → Self Diagnosis → Picture Test</b></li> </ul> <p>If the problem does not appear in the Picture test, make sure:</p> <ul style="list-style-type: none"> <li>• Your connections are all consistent. For example, if you've used the AV In jack on your TV, make sure you have used the AV Out jack on your video source.</li> <li>• You have connected your devices to the correct jacks. For example, if you use the Component jacks, labeled Pb, Pr, and Y, to connect your TV and video source, make sure you have connected the blue Pb jack on the video source to the blue Pb jack on the TV, and the yellow Y jack on the source to the yellow Y jack on the TV.</li> </ul>
Screen Brightness	<p>If you find that the colors on your Samsung TV are correct but just a little too dark or bright, try adjusting the following settings in the Picture menu option of the Main menu:</p> <ul style="list-style-type: none"> <li>• <b>Cell Light, Contrast, Brightness, Sharpness, Color, Tint (G/R)</b> and so on.</li> </ul>

Issues	Solutions and Explanations
Unwanted Powering Off	<p>If your Samsung TV appears to turn off by itself, there may be an issue with either your Timer settings or your Eco friendly <b>No Signal Power Off</b> feature.</p> <p>First make sure <b>Sleep Timer</b> is not accidentally set. The Sleep Timer turns off the TV automatically after a certain period of time has passed.</p> <ul style="list-style-type: none"> <li>• <b>Sleep Timer: User Menu → System → Time → Sleep Timer</b></li> </ul> <p>If the Sleep Timer is not activated, you may have engaged the <b>No Signal Power Off</b> or <b>Auto Power Off</b> feature.</p> <ul style="list-style-type: none"> <li>• <b>No Signal Power Off: User Menu → System → Eco Solution → No Signal Power Off</b></li> <li>• <b>Auto Power Off: User Menu → System → Eco Solution → Auto Power Off</b></li> </ul>
Trouble Powering On	<p><b>Press the Power on button on the TV or remote. The light should blink about 5 times before the TV turns on.</b></p> <p>If you find that you are having trouble powering on your Samsung television, there are a number of things to check before making a call to the service department.</p> <p>If you're sure your power cord, remote control, and PC are functioning properly, you may be having a cable issue. If you have a cable or satellite box, your TV may appear to be off because the cable or satellite box is not outputting a signal. To test the signal output of your cable or satellite box, press the guide or info button on the cable or satellite box remote control. If the screen displays the guide or info data, the problem is caused by the box.</p>
Stand Assembly	<p>If you have any trouble assembling the stand first, review "Install the Stand" in the paper manual.</p>
Cannot Find a Channel	<p>Re-run <b>Setup</b> (Go to <b>User Menu → System → Setup</b>) or run <b>Auto Program</b>. (Go to <b>User Menu → Channel → Auto Program</b>).</p>

 For detailed troubleshooting information, watch the troubleshooting videos at [www.samsung.com/spsn](http://www.samsung.com/spsn).

Issues	Solutions and Explanations
The TV won't turn on.	<ul style="list-style-type: none"> <li>• Make sure the AC power cord is securely plugged in to the wall outlet and the TV.</li> <li>• Make sure the wall outlet is working.</li> <li>• Try pressing the  button on the TV to make sure the problem is not the remote. If the TV turns on, refer to "Remote control does not work" below.</li> </ul>
There is no picture/video.	<ul style="list-style-type: none"> <li>• Check the cable connections. Remove and reconnect all cables connected to the TV and external devices.</li> <li>• Set the video outputs of your external devices (Cable/Sat Box, DVD, Blu-ray etc) to match the TV's input connections. For example, if an external device's output is HDMI, it should be connected to an HDMI input on the TV.</li> <li>• Make sure your connected devices are powered on.</li> <li>• Be sure to select the correct input source.</li> <li>• Reboot the connected device by unplugging it, and then reconnecting the device's power cable.</li> </ul>
The remote control does not work.	<ul style="list-style-type: none"> <li>• Replace the remote control batteries. Make sure the batteries are installed with their poles (+/-) in the correct direction.</li> <li>• Clean the sensor's transmission window on the remote.</li> <li>• Try pointing the remote directly at the TV from 5~6 feet away.</li> </ul>
The cable/set top box remote control doesn't turn the TV on or off, or adjust the volume.	<ul style="list-style-type: none"> <li>• Program the Cable/Set remote control to operate the TV. Refer to the Cable/Set-Top-Box user manual for the SAMSUNG TV code.</li> </ul>

 Some functions and pictures shown in this manual are available on specific models only.

 To keep your TV in optimum condition, upgrade to the latest firmware on the Samsung web site by USB ([samsung.com](http://samsung.com) → Support → Downloads).

## Licenses



## Storage and Maintenance

- ✎ If a sticker was attached to the TV screen, some debris can remain after you remove the sticker. Please clean the debris off before watching TV.
- ✎ The exterior and screen of the product can get scratched during cleaning. Be sure to wipe the exterior and screen carefully using the cloth provided or a soft cloth to prevent scratches.

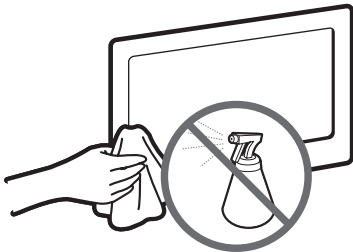

Do not spray water directly onto the product. Any liquid that goes into the product may cause a failure, fire, or electric shock.

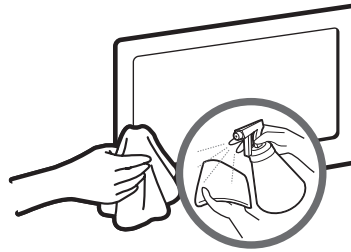

Clean the product with a soft cloth dampened with a small amount of water. Do not use a flammable liquid (e.g. benzene, thinners) or a cleaning agent.

## Securing the TV to the Wall



**Caution: Pulling, pushing, or climbing on the TV may cause the TV to fall. In particular, ensure your children do not hang over or destabilize the TV. Doing so may cause the TV to tip over, causing serious injuries or death. Follow all safety precautions provided in the Safety Flyer included with your TV. For added stability and safety, you can purchase and install the anti-fall device as described below.**

### The TV-Holder Kit (Sold Separately):

The parts below are included in the TV Holder kit. In addition, you need to provide a wood screw, screw and molly, or other screw appropriate for the wall or cabinet you intend to secure the TV-Holder string to. We recommend a size M4xL20 wood screw.



TV-Holder (BN96-15753A)



Screw (M8 X L19)

### Installing the TV-Holder

1. Remove the screw attached to the back of your TV, and then connect the TV-Holder to the TV with the screw included in the TV-Holder Kit that is designated for your TV.
  - ✎ Make sure to use only the appropriate supplied screw. If you use a different screw, you can damage your TV.

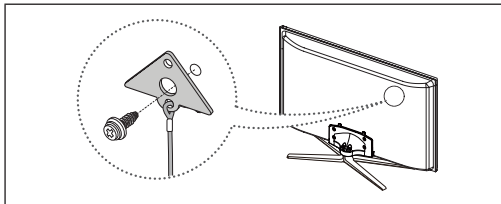

2. Firmly fasten the screw you provided (size M4xL20 or similar) to the wall or cabinet where the TV is to be installed.
  - ✎ If you fasten the screw to the wall, we recommend you drive the screw into a stud. If that is not possible, use a molly to anchor the screw.

3. Tie the TV-Holder cord to the screw fastened to the wall or cabinet so that the TV is fixed. See the illustrations below.
- 🔧 Install the TV close to the wall so that it does not fall.
  - 🔧 When attaching the TV-Holder cord to the wall, tie the cord level with the ground or slanted downwards for safety purposes.
  - 🔧 Check the cord occasionally to make sure it is secure.
  - 🔧 Before moving the TV, separate the connected cord first.

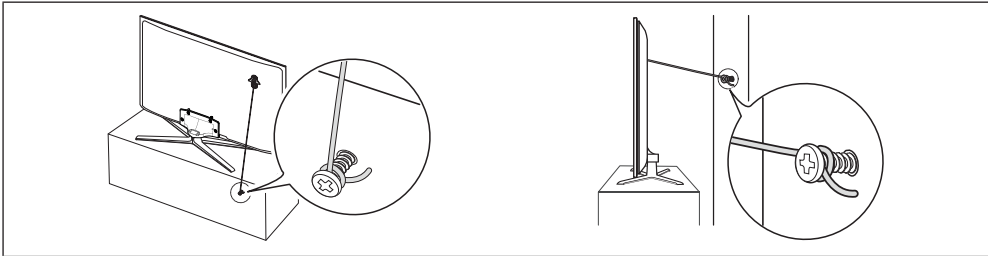

4. Verify all connections are properly secured. Periodically check the connections for any sign of fatigue or failure. If you have any doubt about the security of your connections, contact a professional installer.

**To purchase the TV-Holder Kit, contact Samsung Customer Care**

- In the United States: 1-800-SAMSUNG (1-800-726-7864)
- In Canada: 1-800-SAMSUNG (1-800-726-7864)

## Specifications - Smart Touch Control

Model Name		RMCTPE1
Power	Source	Battery (AA x 2)
		To extend the battery life, use of alkaline battery is recommended
Compatibility	LED TV	Above LED E7500
	PDP TV	E8000
Dimension (W x H x D)		2.0 x 6.1 x 0.7 inches (52.0 x 154.0 x 19.5 mm)
Weight	Without Batteries	0.1 lbs (84.0 g)
	Including Batteries	0.2 lbs (130.0 g)





## Specifications - IR Blaster

Model Name		VG-IRB2000
Power	Source	Battery (AA x 4)
		To extend the battery life, use of alkaline battery is recommended
Compatibility	LED TV	Above LED E7500
	PDP TV	E8000
Dimension (W x H x D)		3.7 x 2.6 x 3.1 inches (95.0 x 65.0 x 79.0 mm)
Weight	Without Batteries	0.1 lbs (86.5 g)
	Including Batteries	0.3 lbs (178.5 g)



## Specifications

Display Resolution	1920 x 1080	
Environmental Considerations		
Operating Temperature	50°F to 104°F (10°C to 40°C)	
Operating Humidity	10% to 80%, non-condensing	
Storage Temperature	-4°F to 113°F (-20°C to 45°C)	
Storage Humidity	5% to 95%, non-condensing	
Stand Swivel (Left / Right)	-20° ~ 20°	
Model Name	PN51E8000	PN60E8000
Screen Size (Diagonal)	51" Class (50.7" measured diagonally)	60" Class (60.0" measured diagonally)
Sound (Output)	10 W X 2	
Dimensions (W x H x D)		
Body	46.9 x 28.0 x 2.1 inches (1193.0 x 713.0 x 55.1 mm)	54.9 x 32.7 x 2.1 inches (1394.6 x 832.6 x 55.1 mm)
With stand	46.9 x 31.7 x 12.1 inches (1193.0 x 806.3 x 309.3 mm)	54.9 x 36.3 x 13.8 inches (1394.6 x 922.8 x 351.6 mm)
Weight		
Without Stand	46.9 lbs (21.3 kg)	61.7 lbs (28.0 kg)
With Stand	52.0 lbs (23.6 kg)	68.7 lbs (31.2 kg)
Model Name	PN64E8000	
Screen Size (Diagonal)	64" Class (64.0" measured diagonally)	
Sound (Output)	10 W X 2	
Dimensions (W x H x D)		
Body	58.4 x 34.7 x 2.1 inches (1485.0 x 882.8 x 55.1 mm)	
With stand	58.4 x 38.2 x 13.8 inches (1485.0 x 971.8 x 351.7 mm)	
Weight		
Without Stand	76.0 lbs (34.5 kg)	
With Stand	83.1 lbs (37.7 kg)	

-  Design and specifications are subject to change without prior notice.
-  The actual appearance of the TV may differ from the images in this manual, depending on the model.
-  This device is a Class B digital apparatus.
-  For information about the power supply, and more about power consumption, refer to the label attached to the product.
-  Typical power consumption is measured according to Energy Star Program requirements for Televisions.

Dispose unwanted electronics through an approved recycler.

To find the nearest recycling location, go to our website:

[www.samsung.com/recyclingdirect](http://www.samsung.com/recyclingdirect) or call, (877) 278 - 0799

## Display Resolution

If you have attached the TV to your PC, you can select one of the standard resolutions listed in the Resolution column. The TV will automatically adjust to the resolution you choose.

Mode	Resolution	Horizontal Frequency (KHz)	Vertical Frequency (Hz)	Pixel Clock Frequency (MHz)	Sync Polarity (H / V)
IBM	640 x 350	31.469	70.086	25.175	+/-
	720 x 400	31.469	70.087	28.322	-/+
MAC	640 x 480	35.000	66.667	30.240	-/-
	832 x 624	49.726	74.551	57.284	-/-
	1152 x 870	68.681	75.062	100.000	-/-
VESA DMT	640 x 480	31.469	59.940	25.175	-/-
	640 x 480	37.861	72.809	31.500	-/-
	640 x 480	37.500	75.000	31.500	-/-
	800 x 600	37.879	60.317	40.000	+/+
	800 x 600	48.077	72.188	50.000	+/+
	800 x 600	46.875	75.000	49.500	+/+
	1024 x 768	48.363	60.004	65.000	-/-
	1024 x 768	56.476	70.069	75.000	-/-
	1024 x 768	60.023	75.029	78.750	+/+
	1152 x 864	67.500	75.000	108.000	+/+
	1280 x 720	45.000	60.000	74.250	+/+
	1280 x 800	49.702	59.810	83.500	-/+
	1280 x 1024	63.981	60.020	108.000	+/+
	1280 x 1024	79.976	75.025	135.000	+/+
	1366 x 768	47.712	59.790	85.500	+/+
	1440 x 900	55.935	59.887	106.500	-/+
1600 x 900RB	60.000	60.000	108.000	+/+	
1680 x 1050	65.290	59.954	146.250	-/+	
1920 x 1080	67.500	60.000	148.500	+/+	







### NOTE

- The interlaced mode is not supported.
- The set might operate abnormally if you select a non-standard video format.

## Video Codec

File Extension	Container	Video Codec	Resolution	Frame rate (fps)	Bit rate (Mbps)	Audio Codec
*.avi	AVI MKV ASF MP4 3GP VRO VOB PS TS	DIVX 3.11/4.x/5.x/6.x	1920 x 1080	6 – 30	30	AC3 LPCM ADMPCM(IMA, MS) AAC HE-AAC WMA DD+ MPEG(MP3) DTS Core G.711(A-Law, μ-Law)
*.mkv		MPEG4 SP/ASP				
*.asf		H.264 BP/MP/HP				
*.wmv		Motion JPEG				
*.mp4		Window Media Video v9	640 x 480	4		
*.mov		MPEG2				
*.3gp		ASF	1920 x 1080	24 / 25 / 30	40	
*.vro		MP4				
*.mpg		3GP	VP6	30		
*.mpeg		VRO	SVAF	8		
*.ts	VOB	MVC	1920 x 1080	24 / 25 / 30	40	
*.tp	PS					
*.trp	TS					
*.mov						
*.flv						
*.vob						
*.svi						
*.m2ts						
*.mts						
*.divx						
*.webm	WebM	VP8		6 – 30	8	Vorbis

### Other Restriction

-  Video content will not play, or not play correctly, if there is an error in the content or the container.
-  Sound or video may not work if the contents have a standard bit rate/frame rate above the compatible Frame/sec listed in the table above.
-  If the Index Table is damaged, the Seek (Jump) function is not supported.
-  When you play video over a network connection, the video may not be played smoothly.
-  The menu may take longer to appear if the video's bit rate exceeds 10Mbps.
-  Some USB/digital camera devices may not be compatible with the player.

### Video decoder

- Supports up to H.264, Level 4.1
- H.264 FMO / ASO / RS, VC1 SP / MP / AP L4 and AVCHD are not supported.
- For all Video codecs except MVC, VP8, VP6:
  - Below 1280 x 720: 60 frame max
  - Above 1280 x 720: 30 frame max
- GMC 2 over is not supported.
- Supports only SVAF Top/Bottom and Side by Side.
- Supports only BD MVC Spec.

### Audio decoder

- WMA 10 Pro supports up to 5.1 channel. WMA lossless audio is not supported.
- QCELP, AMR NB/WB are not supported.
- If Vorbis is only in Webm container, supports up to 2 channel.

## Dimensions

### ■ Jack panel detail / Rear view

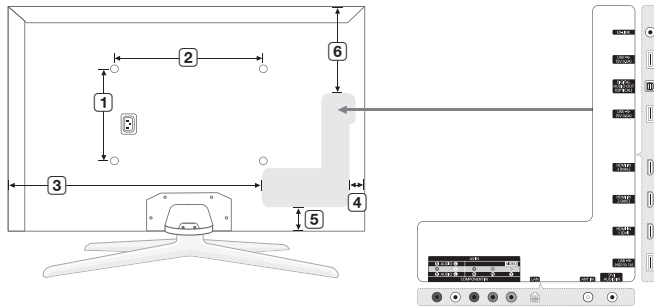

(Unit: inches)

Model name	1	2	3	4	5	6
PN51E8000	15.7	15.7	33.1	3.2	4.8	11.3
PN60E8000	15.7	23.6	39.8	2.8	4.3	14.2
PN64E8000	15.7	23.6	42.9	5.5	6.3	16.1

**NOTE:** All drawings are not necessarily to scale. Some dimensions are subject to change without prior notice. Refer to the dimensions prior to performing installation of your TV. Not responsible for typographical or printed errors.

© 2012 Samsung Electronics America, Inc

## Index

### A

Auto Program ..... 19

### C

Calibrating the Touch Pad ..... 40

Changing the Input Source ..... 25

Clock ..... 20

Configuring

the Basic Settings in Initial Setup ..... 17

Connecting the Power Cord  
and the Antenna or Cable Connection ..... 13

Connecting to a Network ..... 35

Connecting to a PC ..... 24

Connecting to Audio Devices ..... 23

Connecting to AV Devices ..... 21

Controlling the TV

with your hands using motions ..... 31

### D

Display Resolution ..... 58

### F

Face recognition ..... 32

### H

Howling ..... 28

How to Use Edit Name ..... 25

How to view the e-Manual ..... 48

### I

Initial Pairing for Smart Touch Control ..... 40

Installing the Wall Mount (Optional) ..... 9

IR Blaster Pairing ..... 44

### L

Language ..... 28

Licenses ..... 53

### M

Menu Language ..... 17

Motion Control ..... 30

Motion Control Environment Test ..... 30

Motion Guide Bar Size ..... 30

### S

Securing the TV to the Wall ..... 54

Setting up the Universal Remote Control ..... 45

SMART Interaction ..... 27

Software Upgrade ..... 19

Specifications ..... 57

Store Demo ..... 17

### T

The Evolution Kit Slot (Kit Sold Separately) ..... 34

The IR Blaster ..... 43

The Smart Touch Control ..... 39

To Change

the screen position of the e-Manual ..... 49

To register

your face in your Samsung account ..... 32

Trigger Words ..... 28

Troubleshooting ..... 50

### U

Use Mode ..... 17

Using Smart Hub ..... 26

Using the Touch Pad ..... 41

Using the TV's Controller (Panel Key) ..... 12

Using the Voice Text Input Mode ..... 29

### V

Video Codec ..... 59

Voice Command Bar Size ..... 28

Voice Control ..... 27

Voice Control Environment Test ..... 29

Voice Sensitivity ..... 28

## Federal Communication Commission Interference Statement

This equipment has been tested and found to comply with the limits for a Class B digital device, pursuant to Part 15 of the FCC Rules. These limits are designed to provide reasonable protection against harmful interference in a residential installation. This equipment generates, uses and can radiate radio frequency energy and, if not installed and used in accordance with the instructions, may cause harmful interference to radio communications. However, there is no guarantee that interference will not occur in a particular installation. If this equipment does cause harmful interference to radio or television reception, which can be determined by turning the equipment off and on, the user is encouraged to try to correct the interference by one of the following measures:

- Reorient or relocate the receiving antenna.
- Increase the separation between the equipment and receiver.
- Connect the equipment into an outlet on a circuit different from that to which the receiver is connected.
- Consult the dealer or an experienced radio/TV technician for help.

FCC Caution: Any changes or modifications not expressly approved by the party responsible for compliance could void the user's authority to operate this equipment.

This device complies with Part 15 of the FCC Rules. Operation is subject to the following two conditions: (1) This device may not cause harmful interference, and (2) this device must accept any interference received, including interference that may cause undesired operation.

For product available in the USA/Canada market, only channel 1~11 can be operated. Selection of other channels is not possible.

This device and its antenna(s) must not be co-located or operation in conjunction with any other antenna or transmitter.

### **FCC Radiation Exposure Statement:**

This equipment complies with FCC radiation exposure limits set forth for an uncontrolled environment. This equipment should be installed and operated with minimum distance 20cm between the radiator & your body.

**This Class B digital apparatus complies with Canadian ICES-003.**

Cet appareil numérique de la classe B conforme à la norme NMB-003 du Canada.

This device complies with Industry Canada license-exempt RSS standard(s). Operation is subject to the following two conditions: (1) this device may not cause interference, and (2) this device must accept any interference, including interference that may cause undesired operation of the device.

Le présent appareil est conforme aux CNR d'Industrie Canada applicables aux appareils radio exempts de licence. L'exploitation est autorisée aux deux conditions suivantes : (1) l'appareil ne doit pas produire de brouillage, et (2) l'utilisateur de l'appareil doit accepter tout brouillage radioélectrique subi, même si le brouillage est susceptible d'en compromettre le fonctionnement.

For product available in the USA/Canada market, only channel 1~11 can be operated. Selection of other channels is not possible.

This device and its antenna(s) must not be co-located or operation in conjunction with any other antenna or transmitter.

Under Industry Canada regulations, this radio transmitter may only operate using an antenna of a type and maximum (or lesser) gain approved for the transmitter by Industry Canada. To reduce potential radio interference to other users, the antenna type and its gain should be so chosen that the equivalent isotropically radiated power (e.i.r.p.) is not more than that necessary for successful communication.

IC Radiation Exposure Statement:

This equipment complies with IC RSS-102 radiation exposure limits set forth for an uncontrolled environment. This equipment should be installed and operated with minimum distance 20cm between the radiator & your body.